

CAD Final Project

LOCOMOTIVATION

한양대학교 미래자동차공학과

2013020381 김우현

2013020303 공필식

2013020693 황인준

Contents

- 팀 소개
- 모델 선정 이유
- 모델링에 참고한 자료
- 모델링
- 키네마틱





팀 소개

LOCO MOTIVATION



모델 선정 이유

Reason for Selection

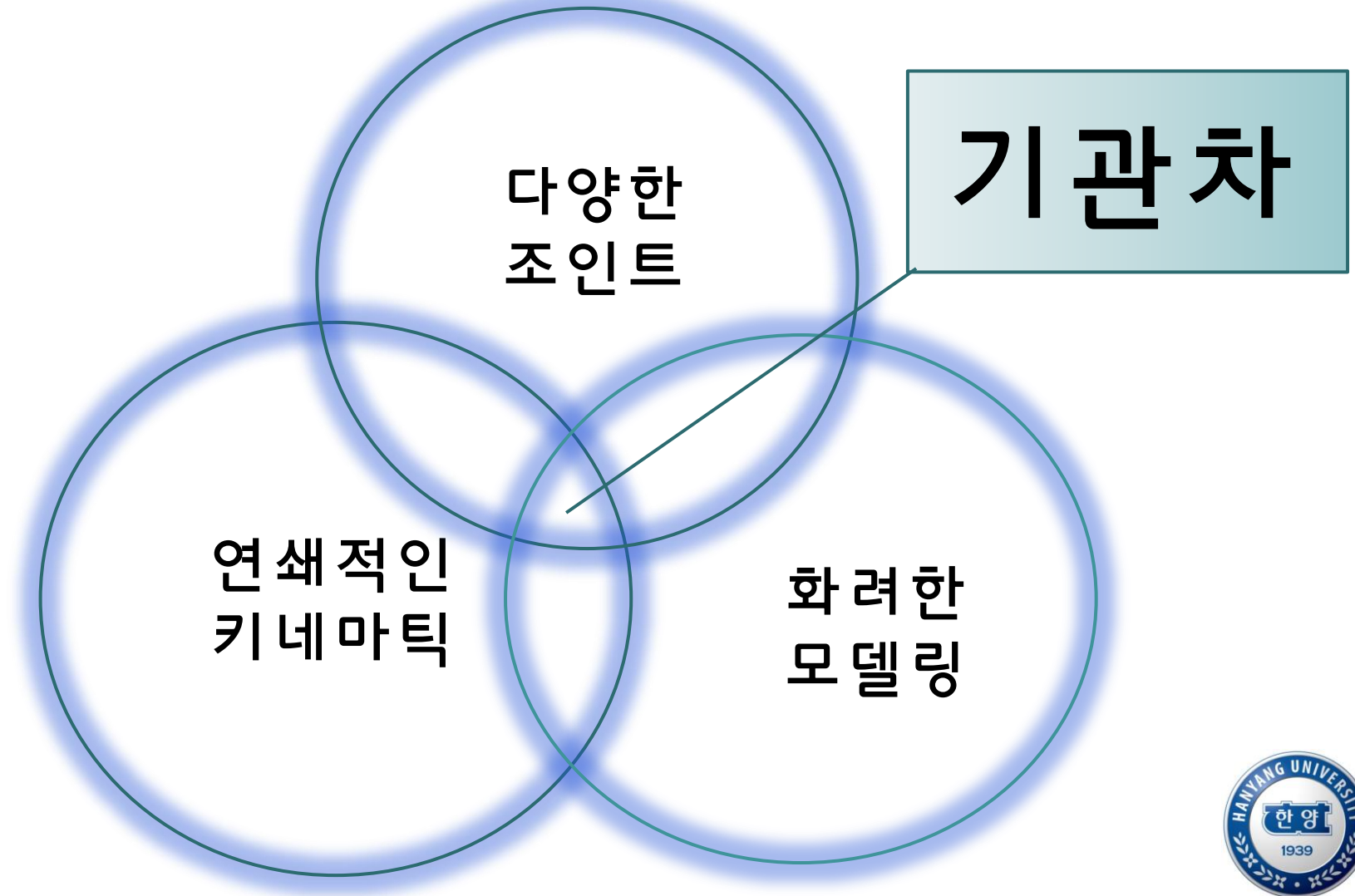



참고자료

참고자료

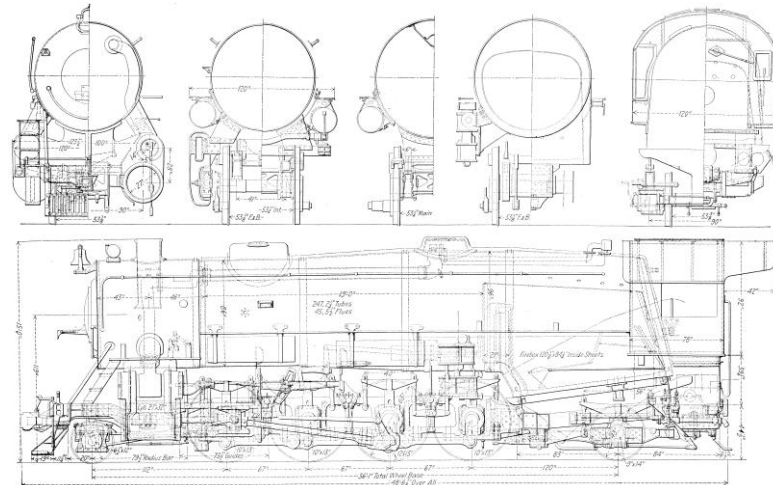
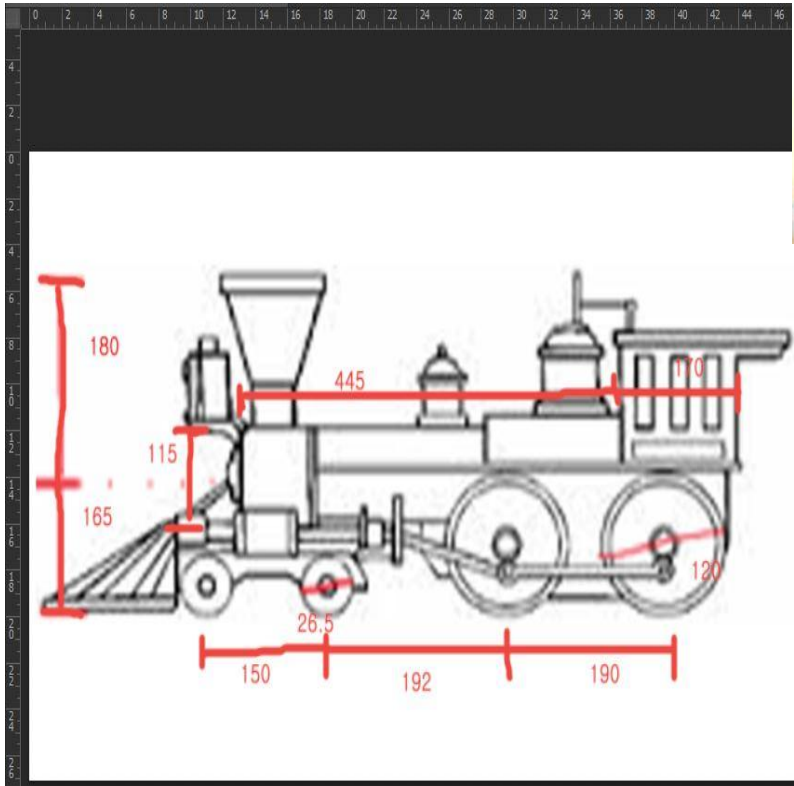



무뎉깁

Modeling

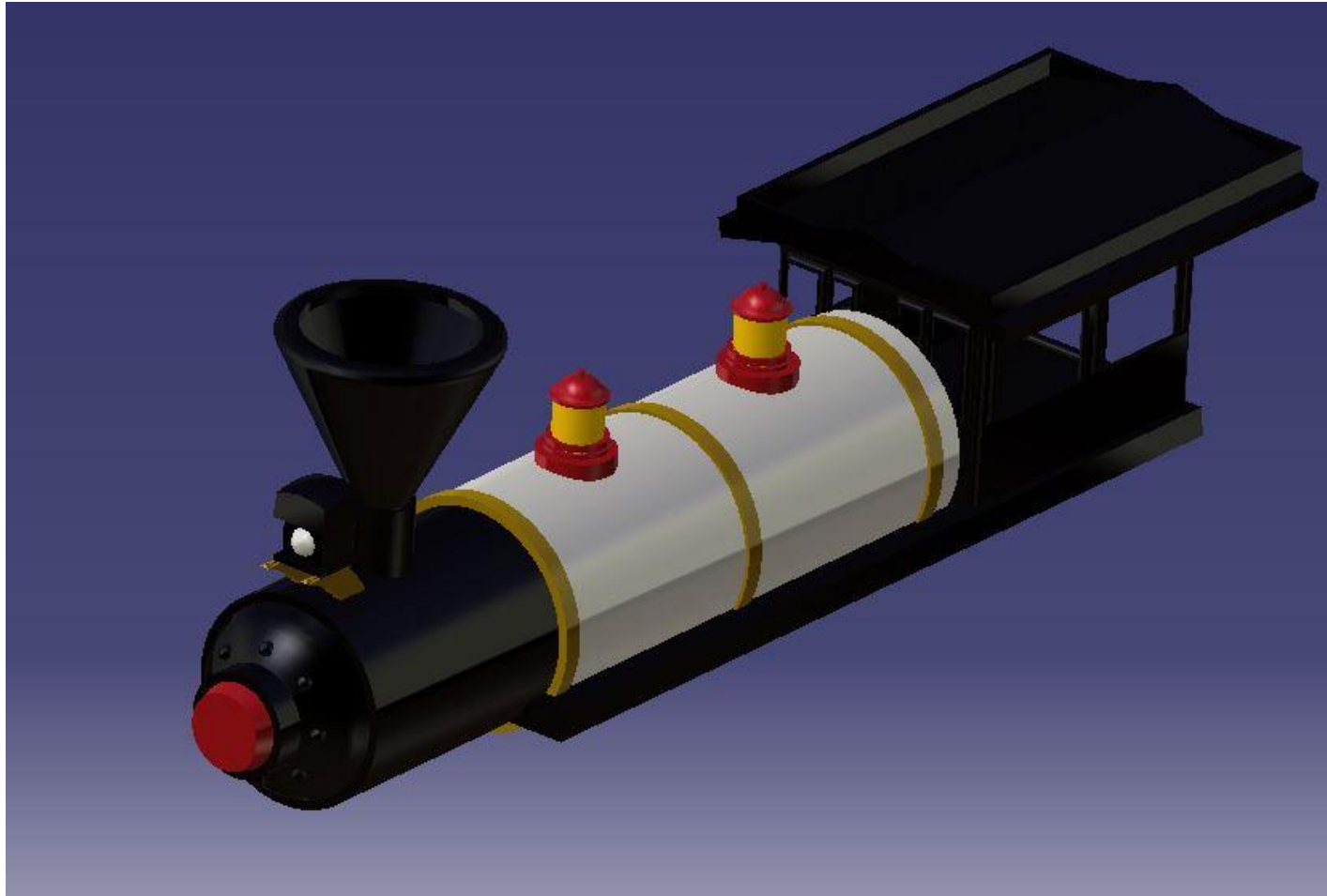

Front Deco

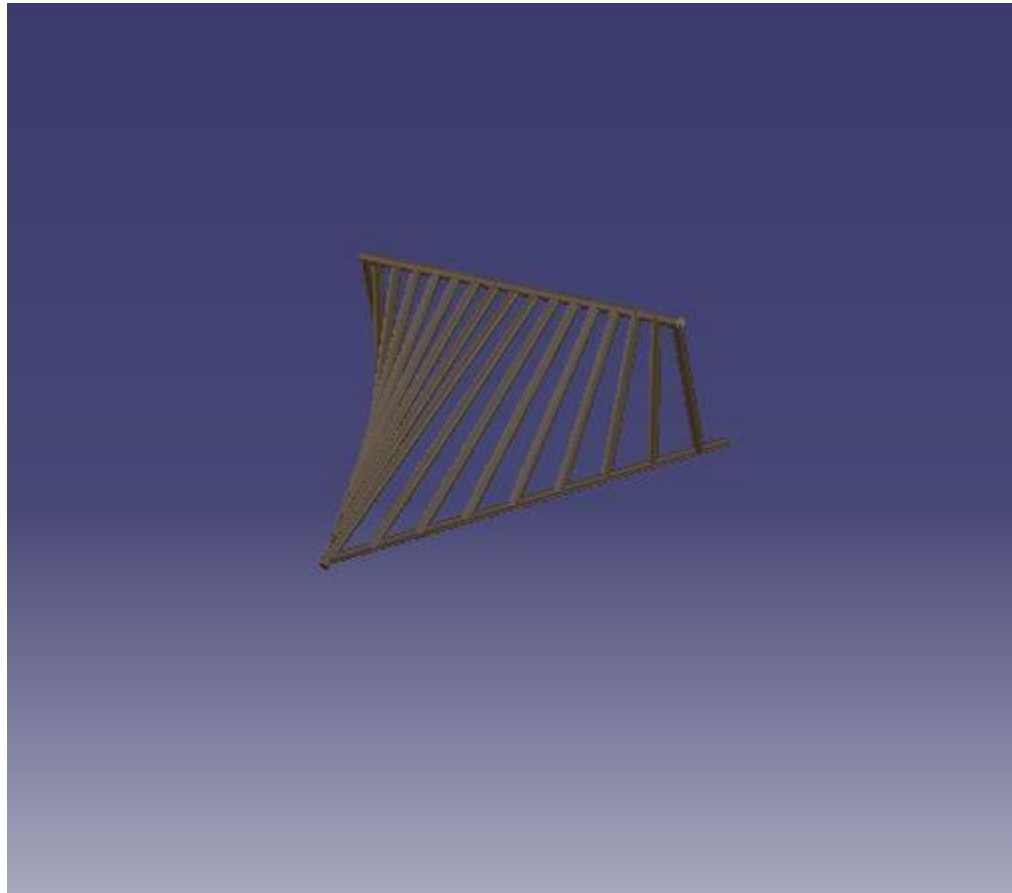

Front Deco

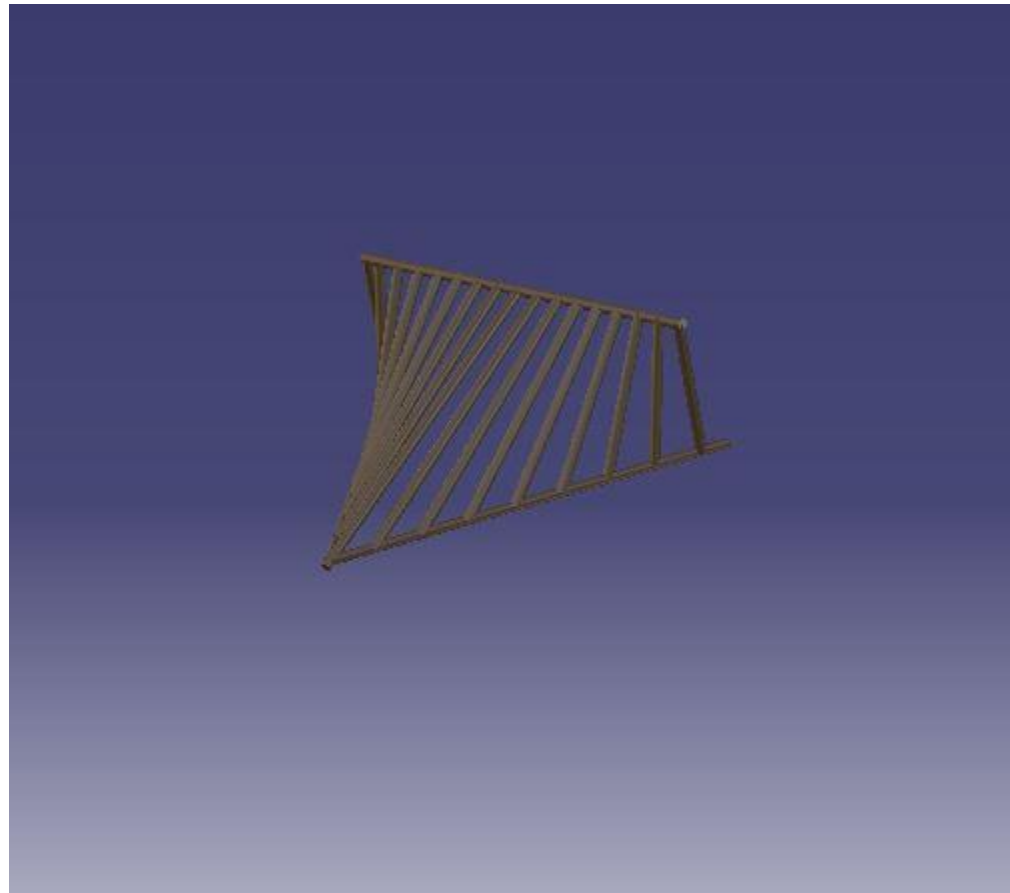

Engine Room

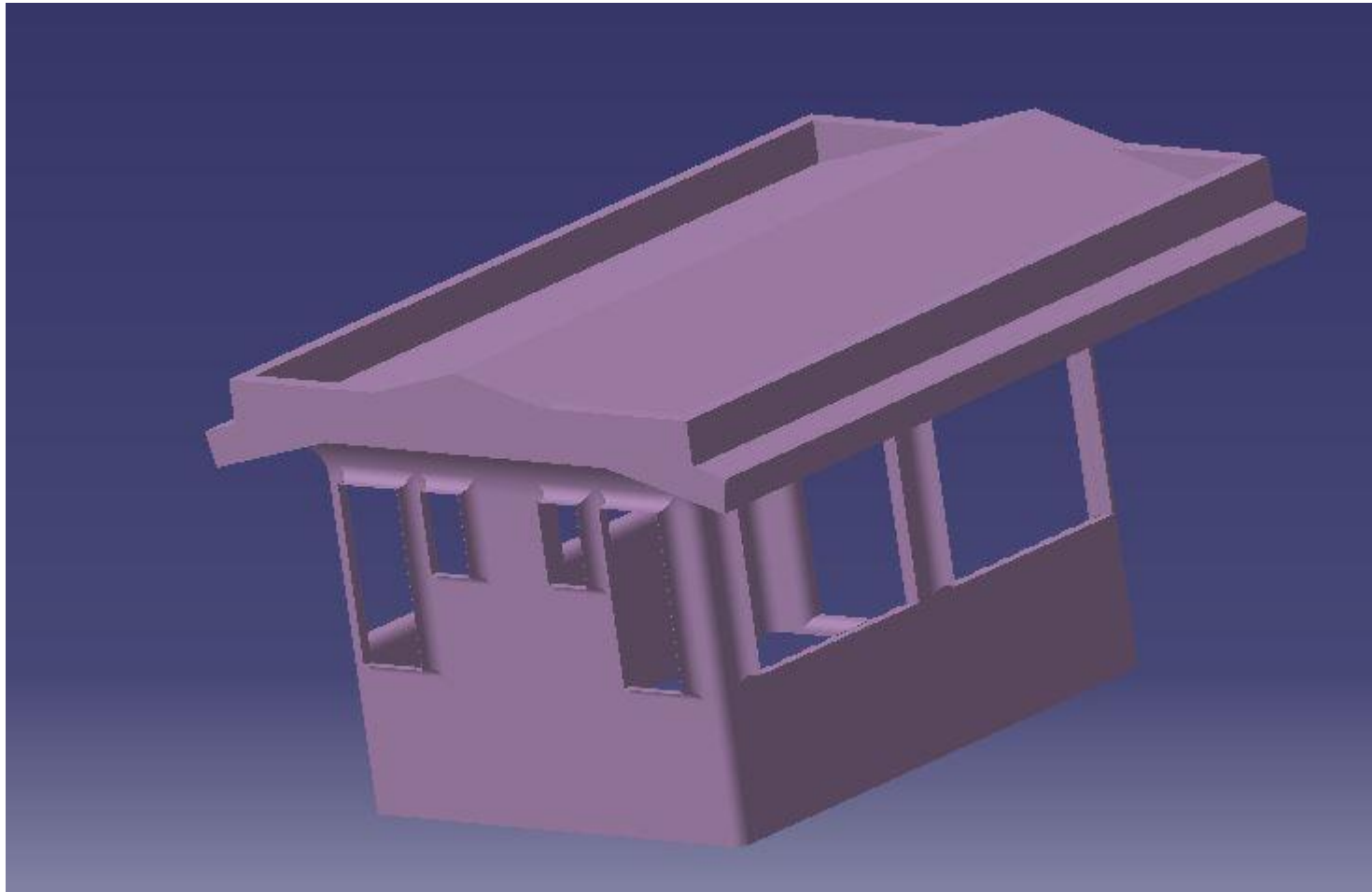

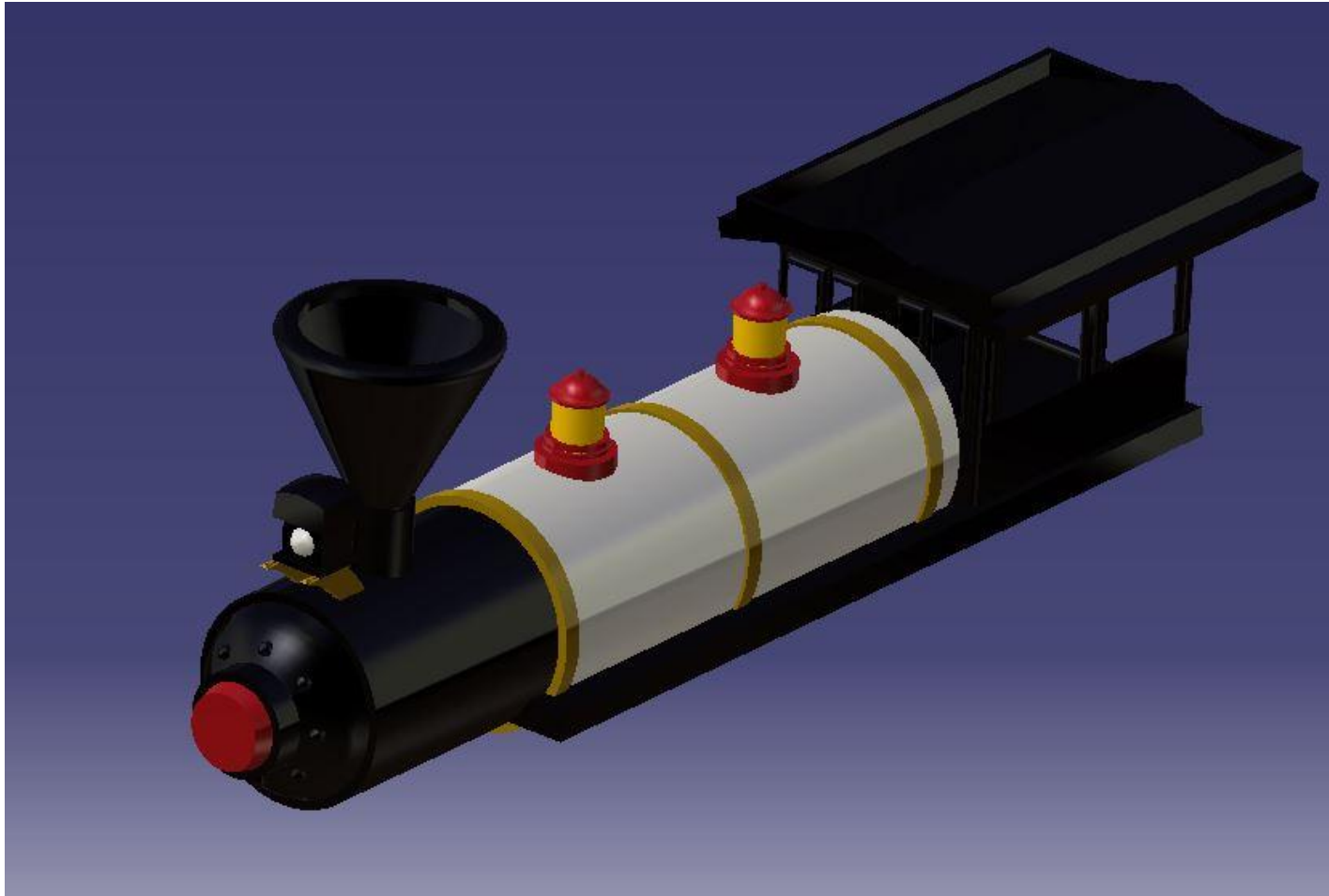

Chassis

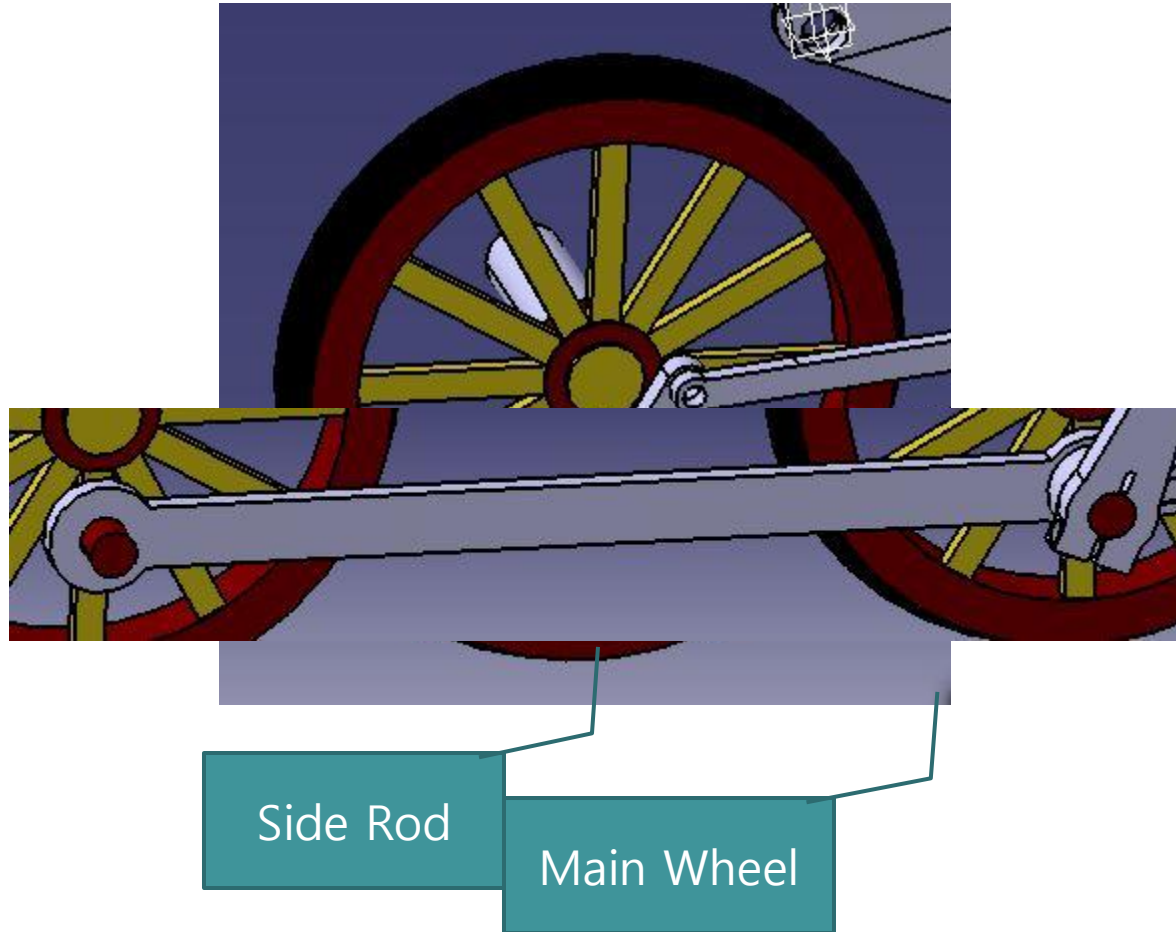

Chassis

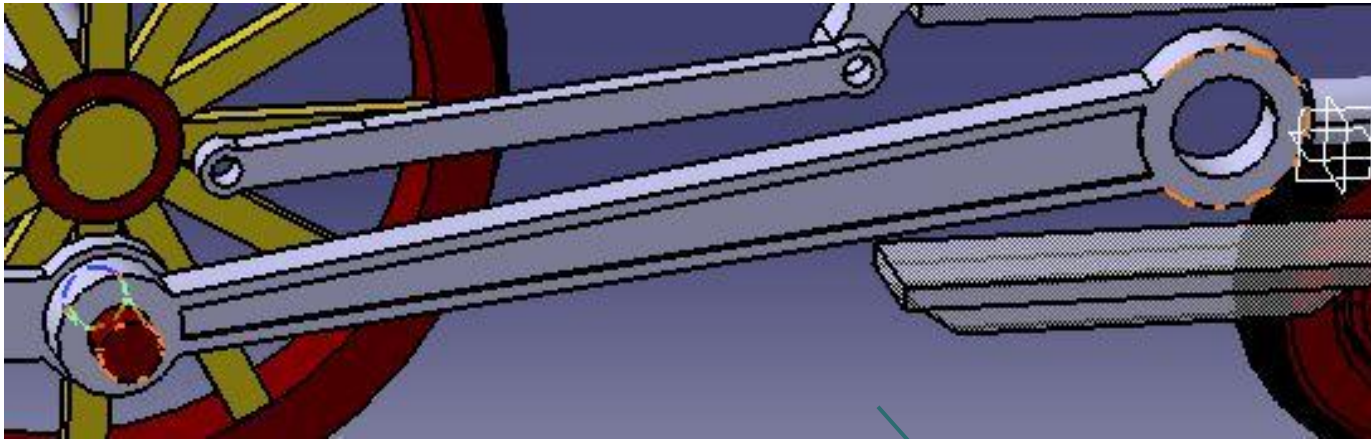

Cross Head

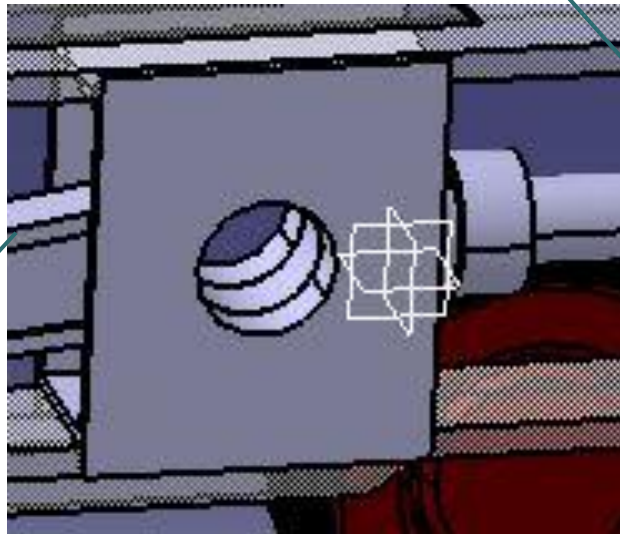

Main Rod

Chassis

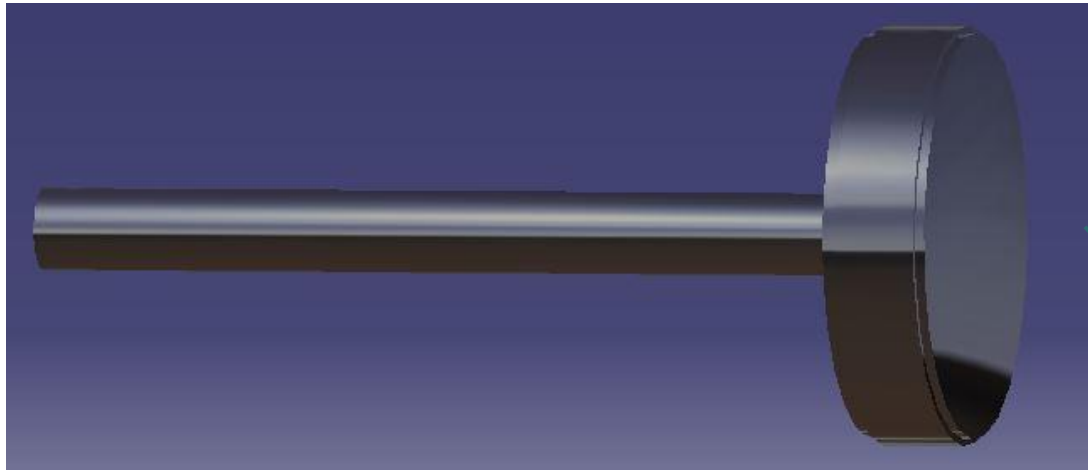

Piston

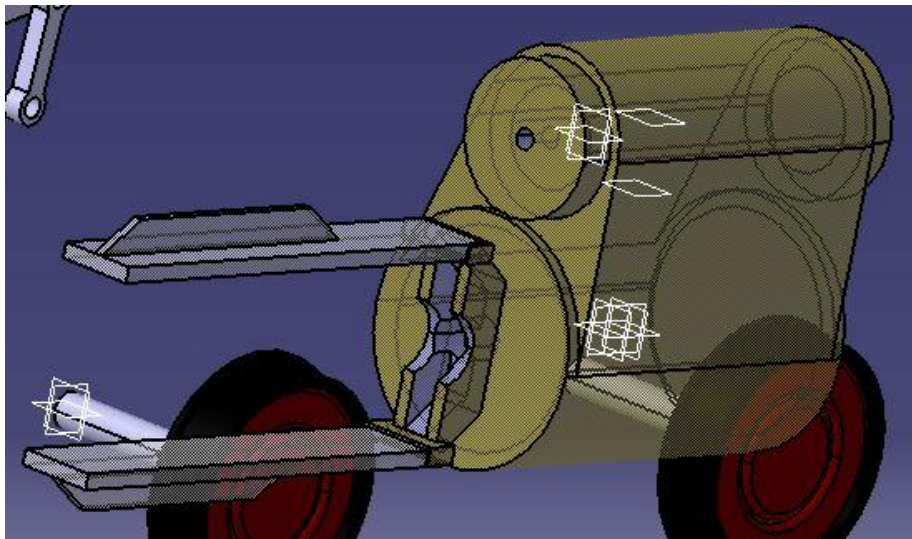

Cylinder

Chassis

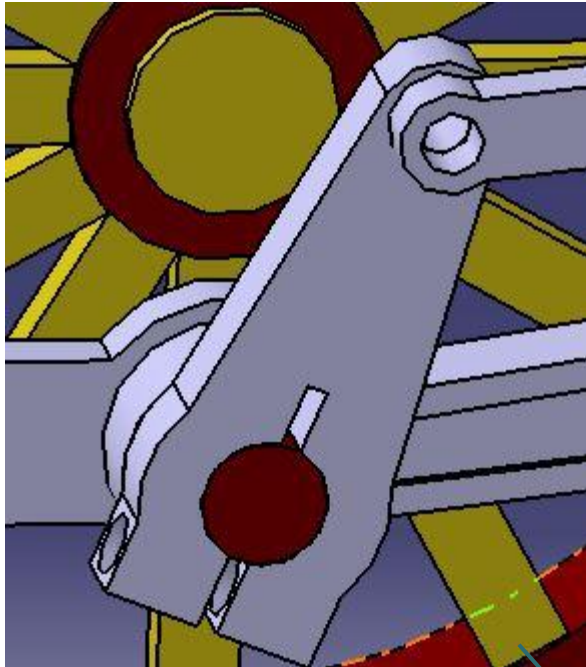

Fly Crank
Rod

Fly Crank

Chassis

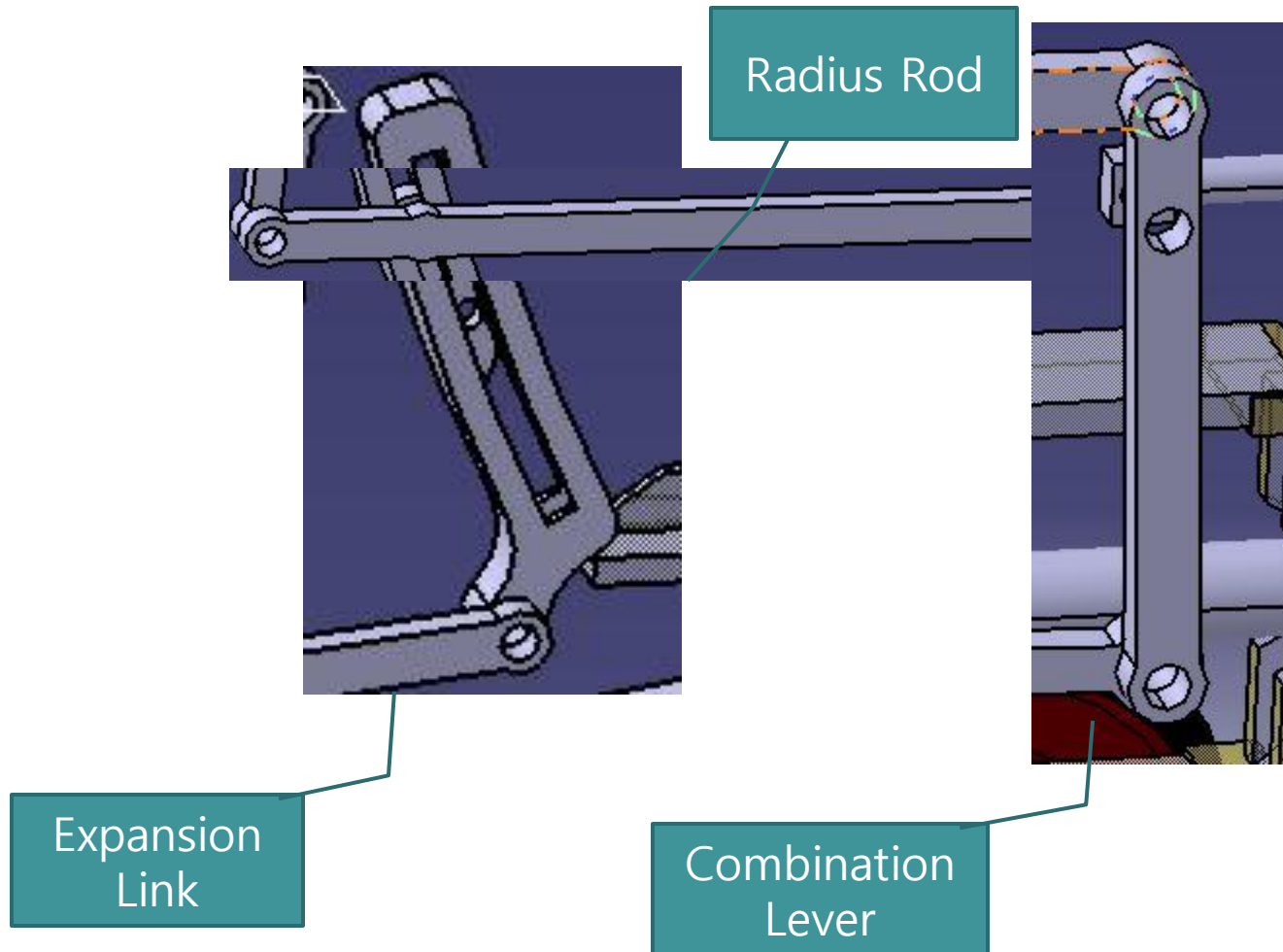

Chassis

Lifting Arm

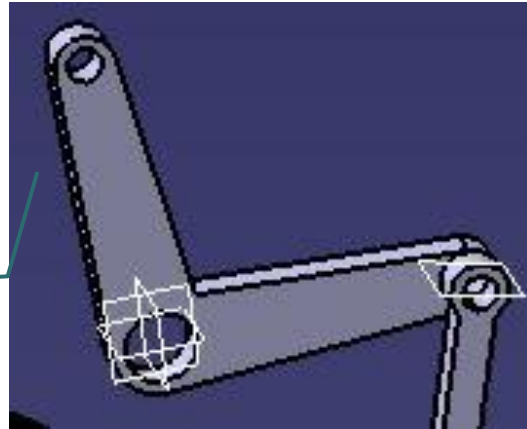

Lifting Link



Valve Piton

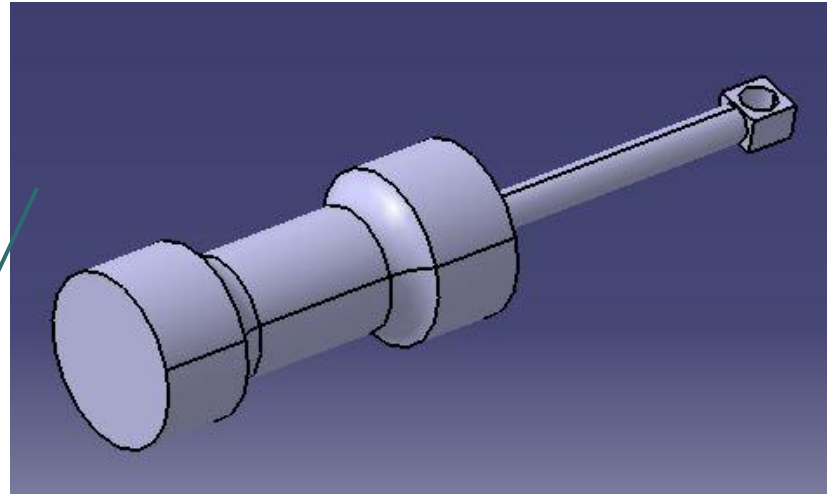

Freight Car

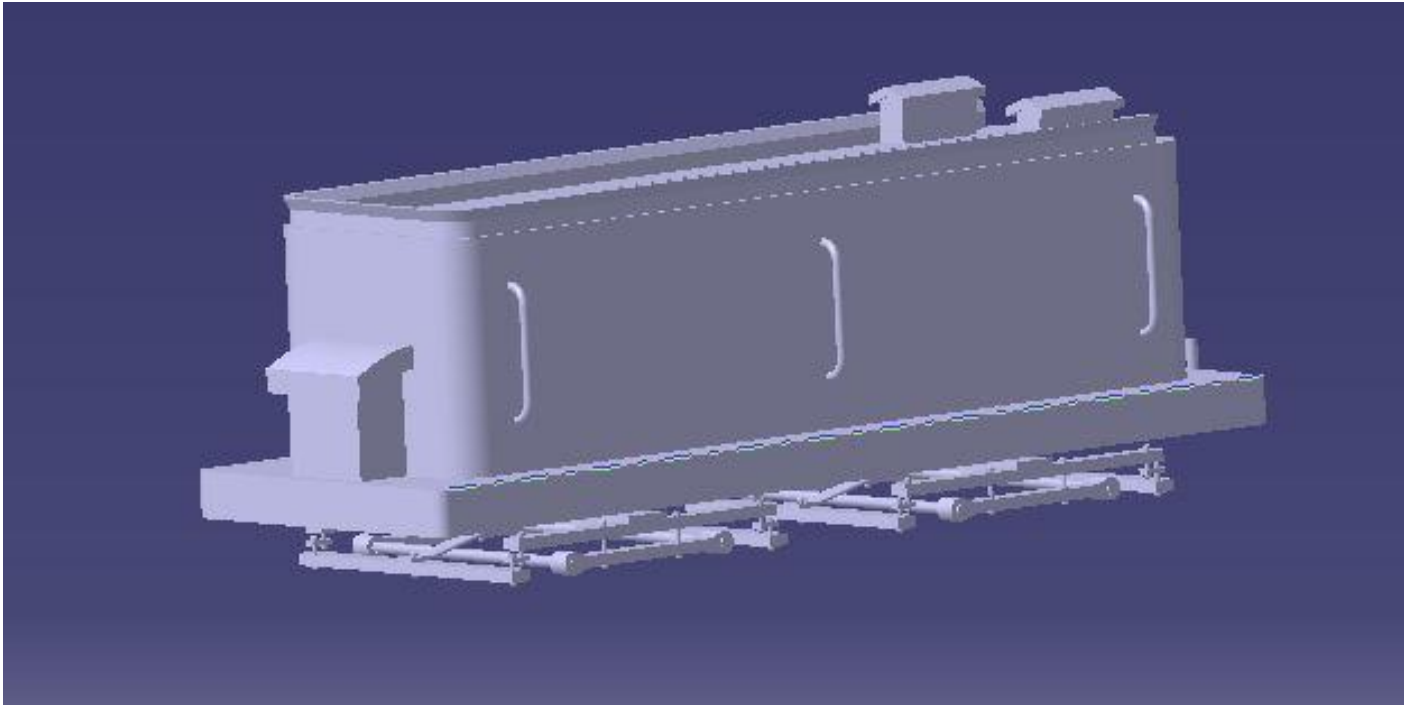

Freight Car

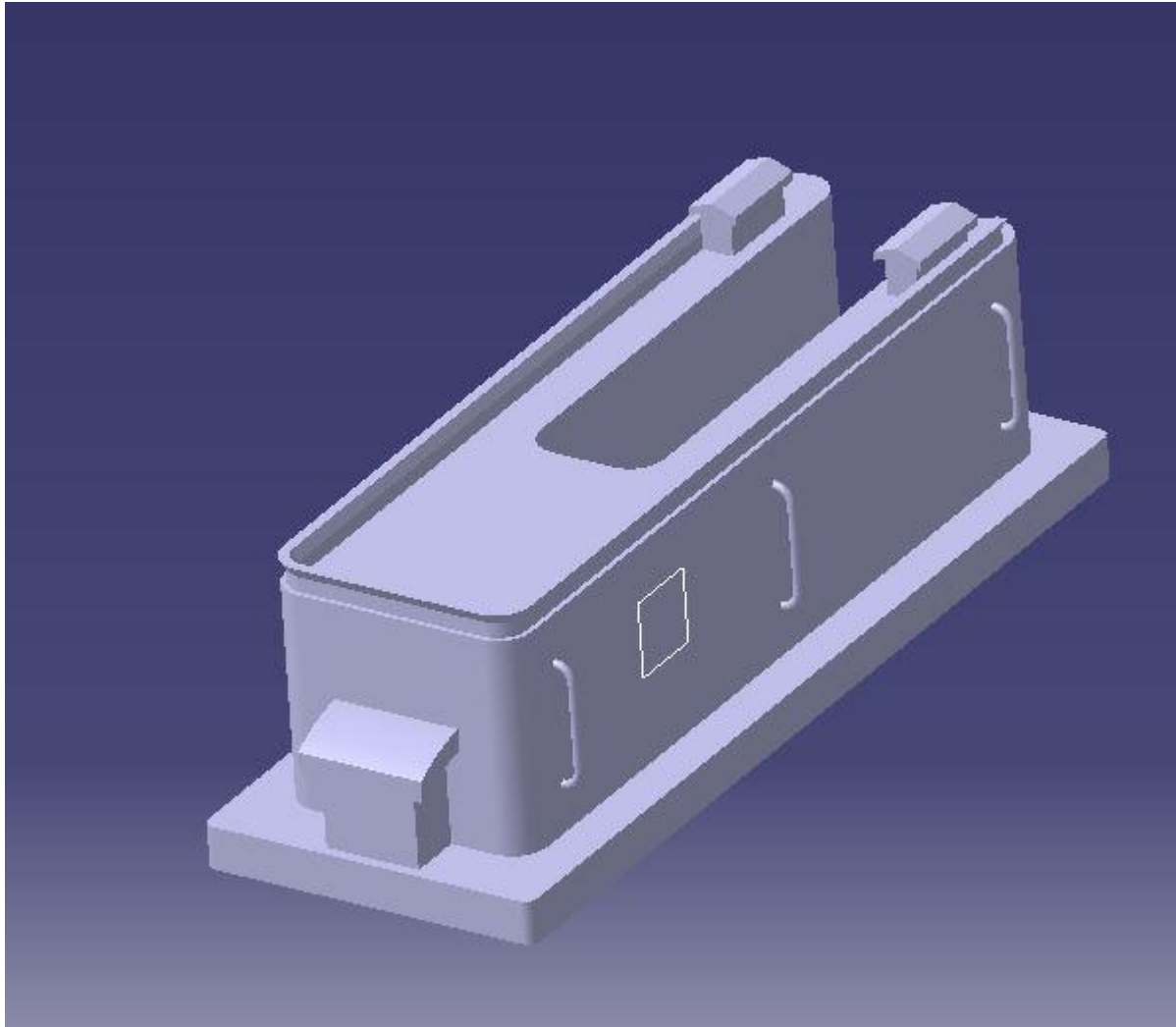

Freight Car

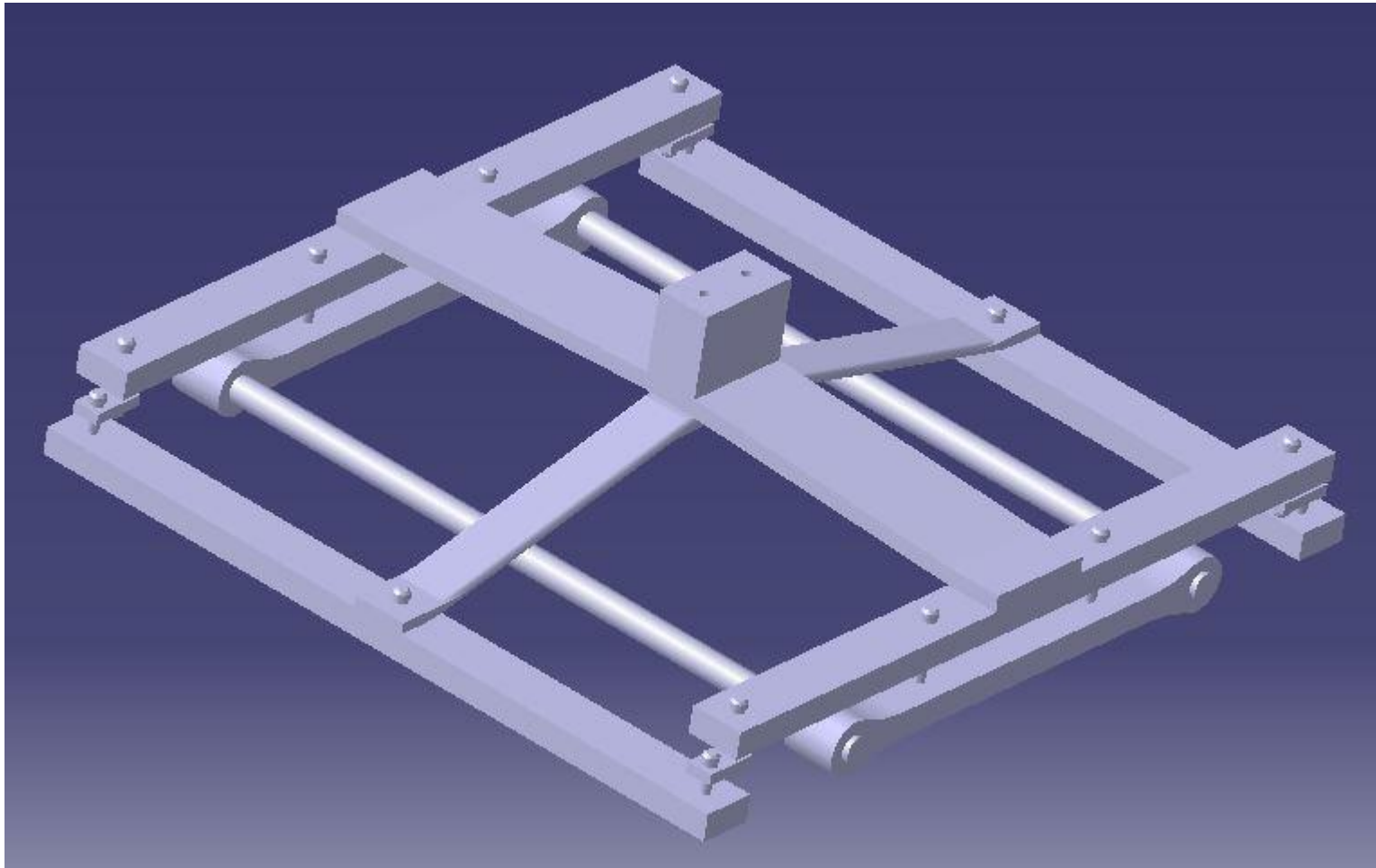

Rail

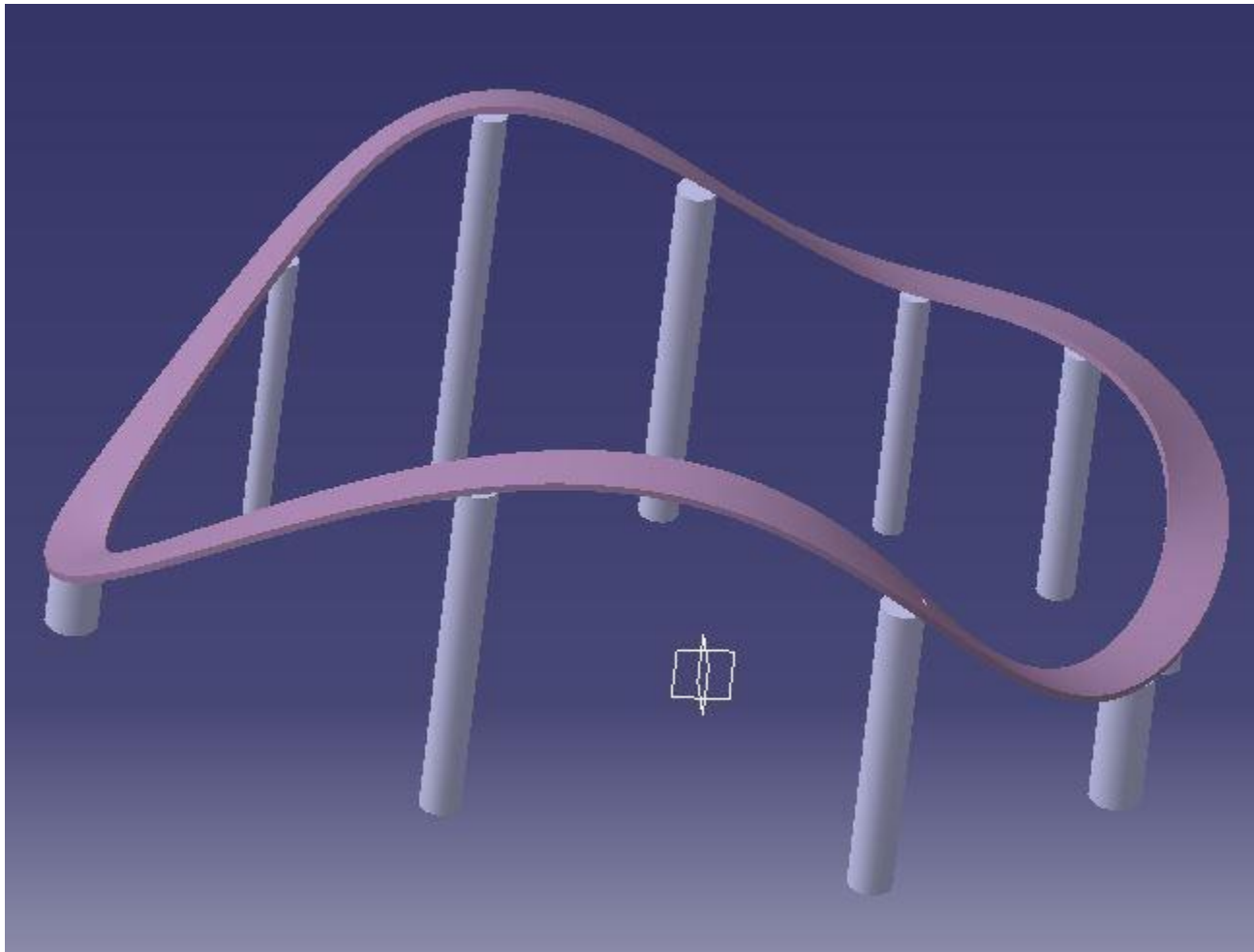

Rail

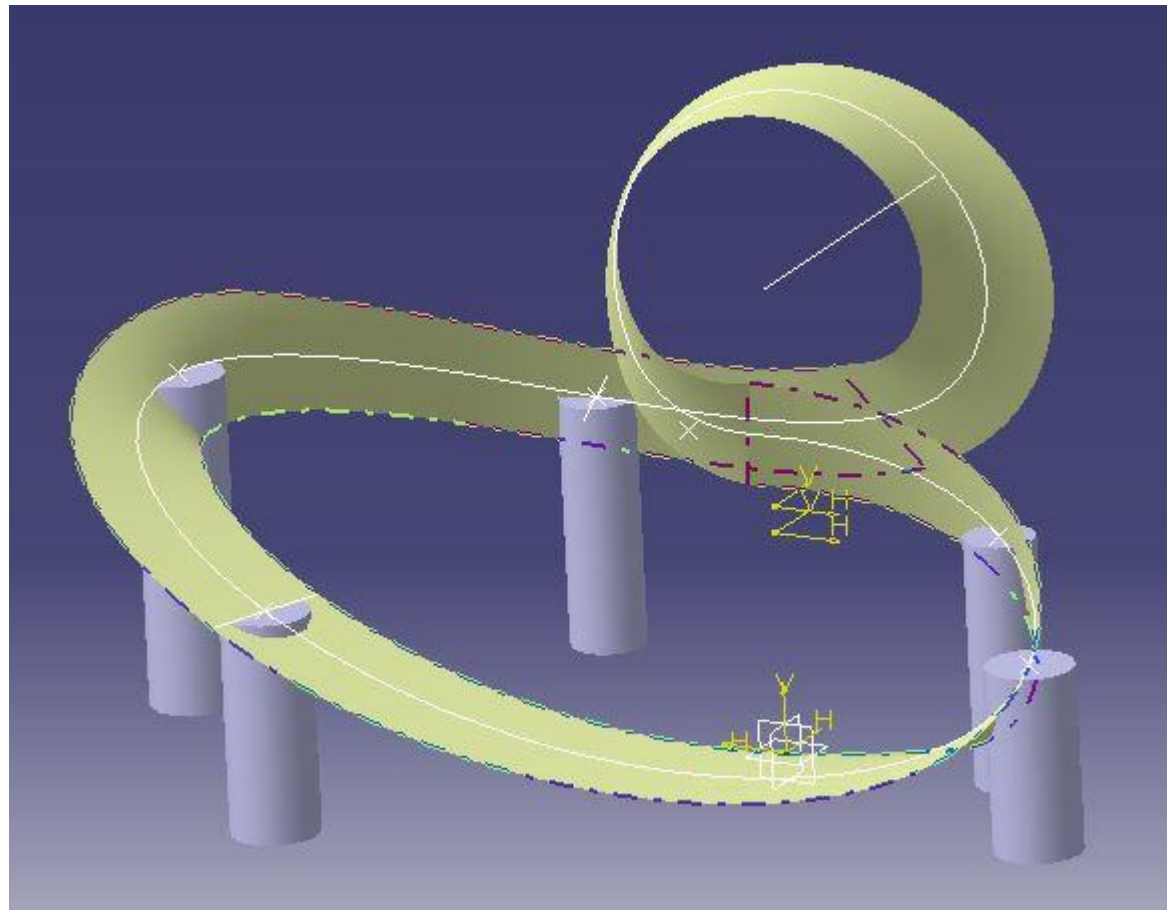

Rail

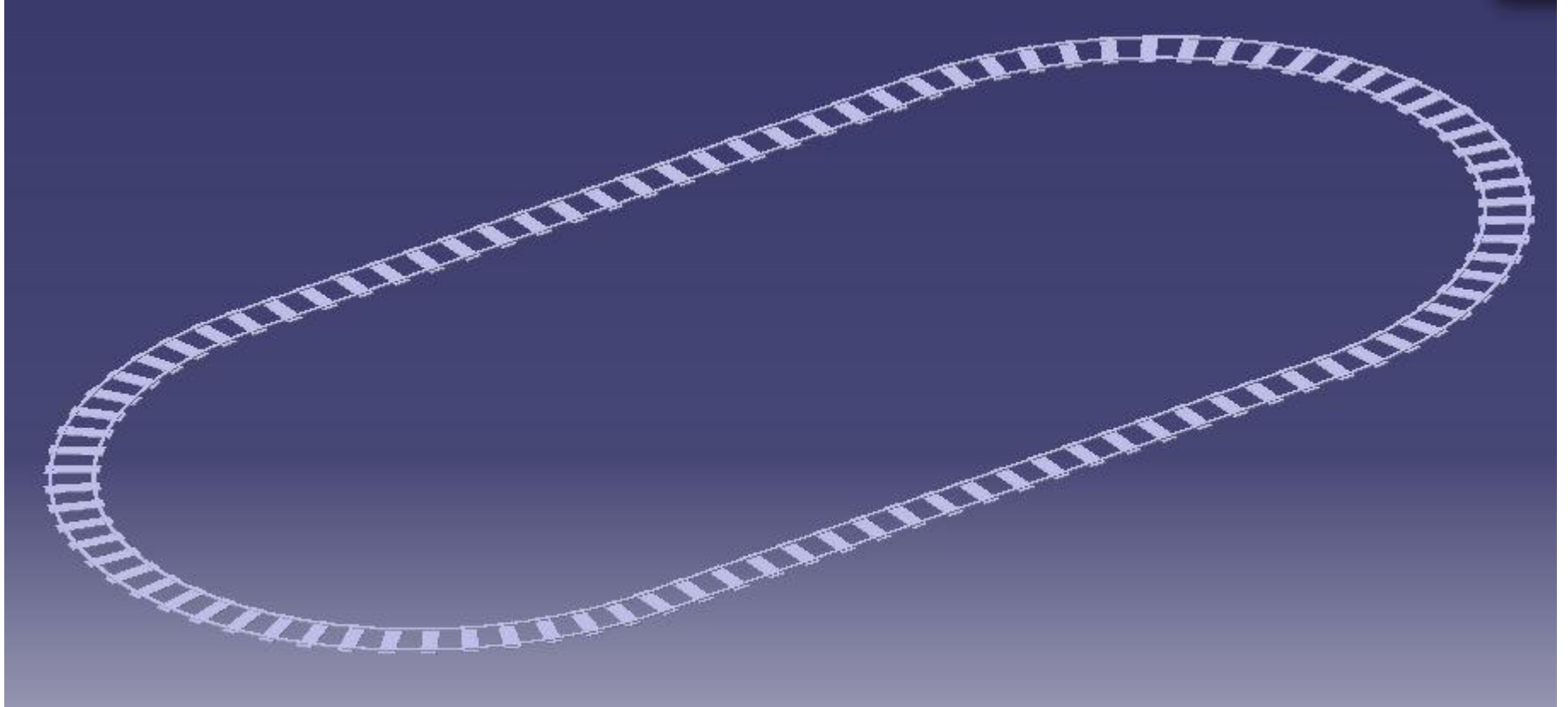



키네마틱

Kinematic

ROUNDHOUSE

Walschaerts Valve-Gear

This kit contains parts to construct a set of Walschaerts type valve-gear as used on **ROUNDHOUSE** locomotives. It is of a simplified design, which does not use a combination lever and is intended for use with the **ROUNDHOUSE** Cylinder set.

NOTE:- Frames, Cylinders, Coupling Rods, Connecting Rods, Axles and Outside Cranks are not included with this set of parts.

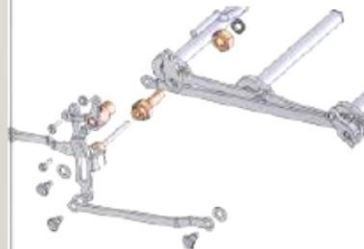

Roundhouse Engineering Co. Ltd

Units 6 to 9, Churchill Business Park,
Churchill Road, Wheatley,
Doncaster, DN1 2TF, England.
Tel 01302 328035 Fax 01302 761312
Email: mail@roundhouse-eng.com
www.roundhouse-eng.com

This pack contains the following parts: -

- 2 Return Cranks with steel screws & nuts.
 - 2 Expansion links with bushes & 2BA nuts.
 - 2 Lifting arms with grub screws & Allen key.
 - 2 Lifting links.
 - 4 M2 steel screws & nuts.
 - 6 5BA steel washers.
 - 2 Radius rods.
 - 2 Weigh shaft brackets
 - 1 Weigh shaft.
 - 2 Starlock washers
 - 2 Roll pins.
 - 6 Short crank pins.
 - 2 Plain crank pins
-
- 1 Push Rod Connector, Screw & Starlock.
 - 1 Stainless Steel spring & Long Crank Pin.
 - 1 Reversing lever handle.
 - 1 Reversing lever base.
 - 3 M2 screws and nuts.
 - 2 M3 mounting screws.
-
- 1 Steel push rod & quicklink connector.
 - 2 Eccentric rods.



Kinematic



<https://www.youtube.com/watch?v=HKH9TYhz3LA>



Kinematic

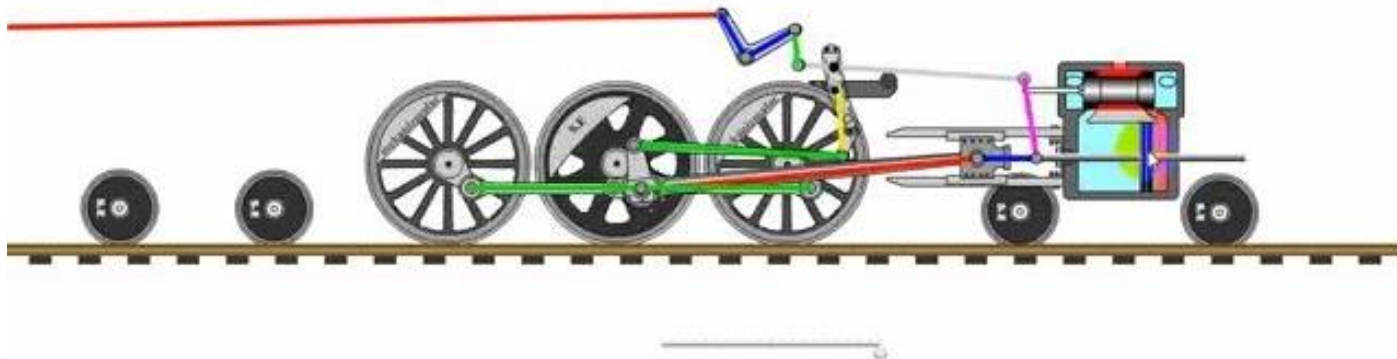

Steam locomotive linkage system



mekanizmalar · 동영상 171개

 구독 8,153

3,421

 33  2

<https://www.youtube.com/watch?v=8yRVMnPJmdQ>



Kinematic

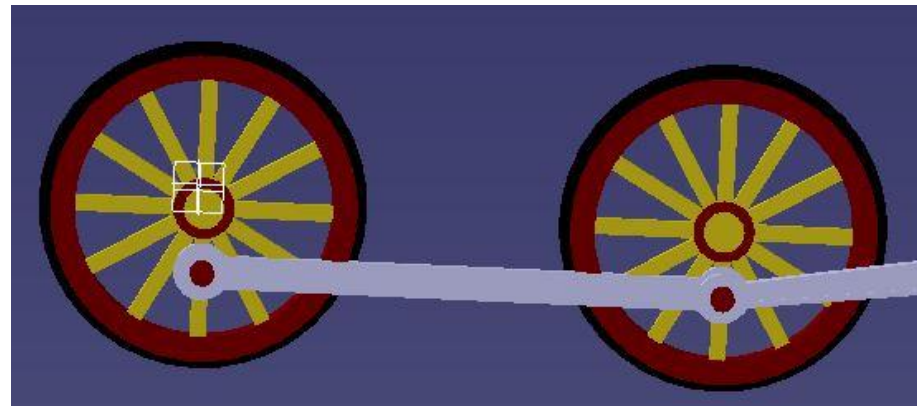
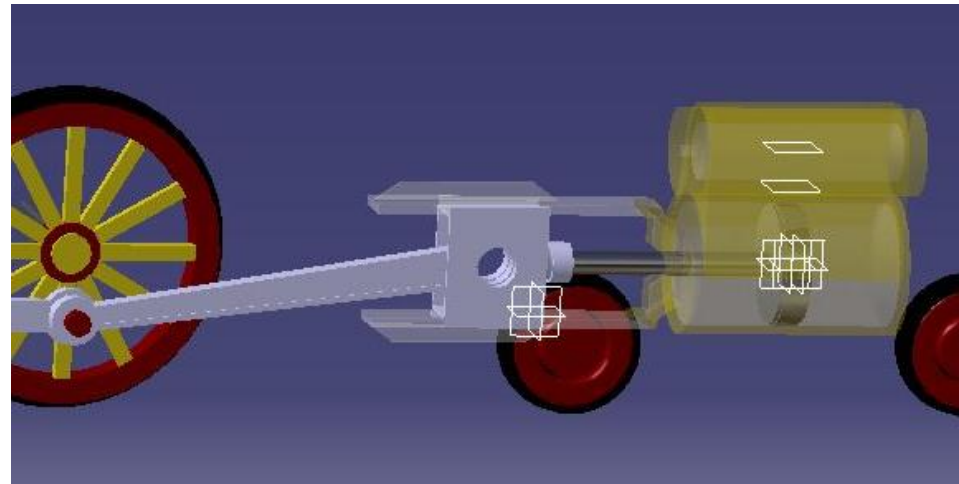
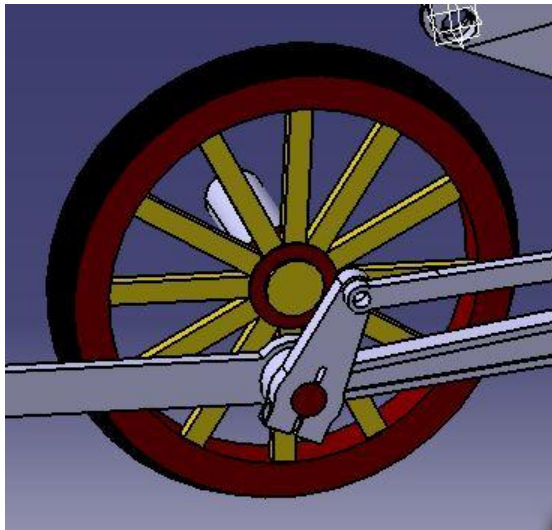

Kinematic

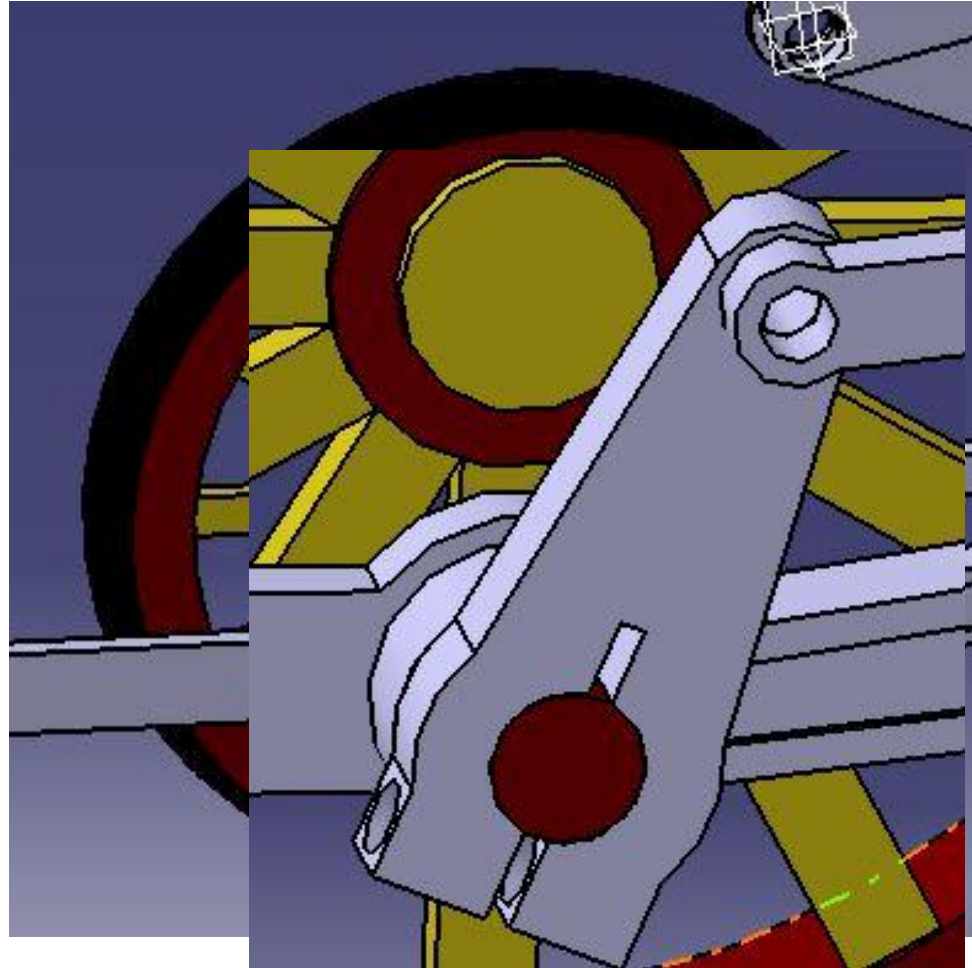

Kinematic

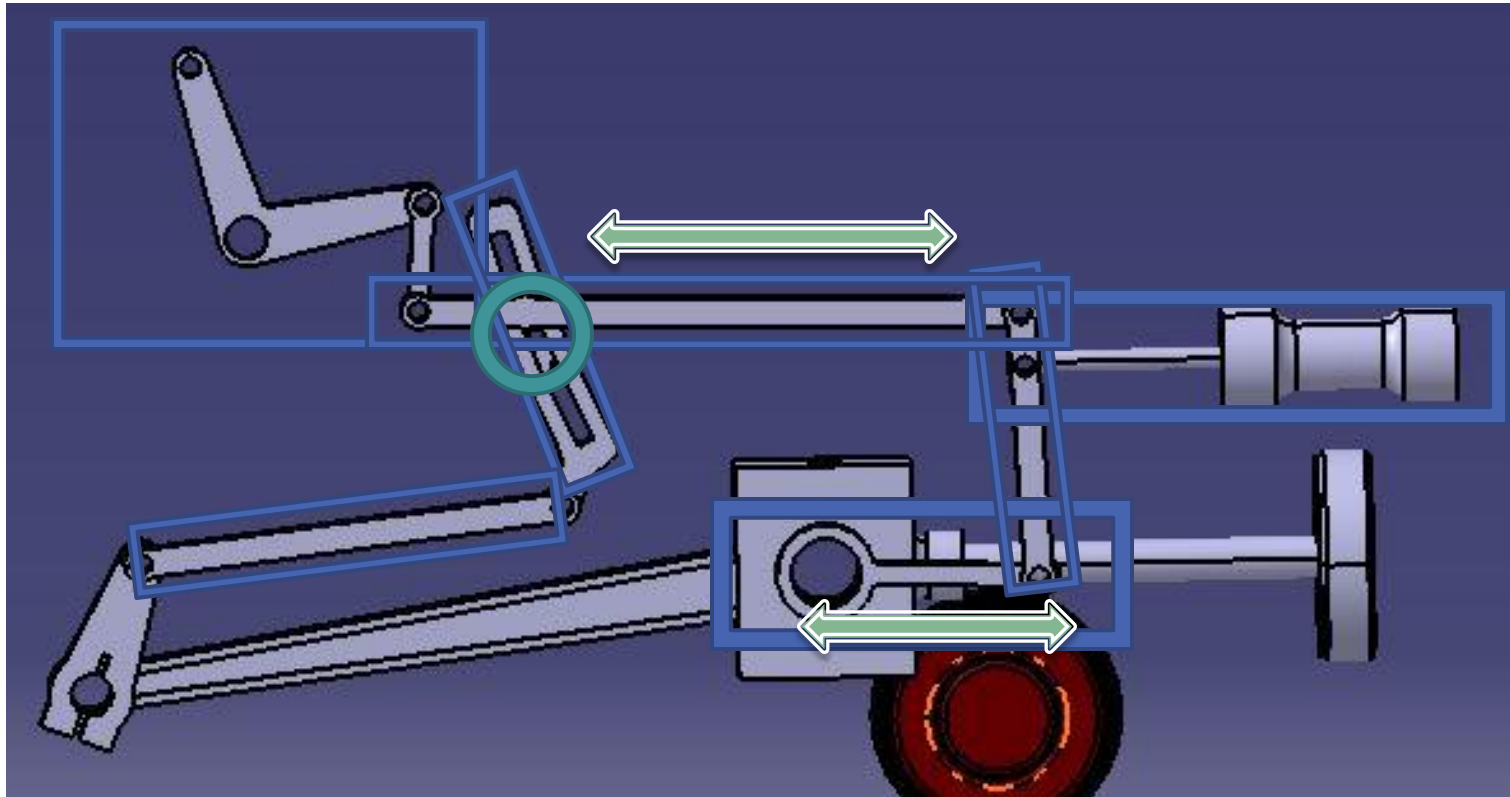

Kinematic

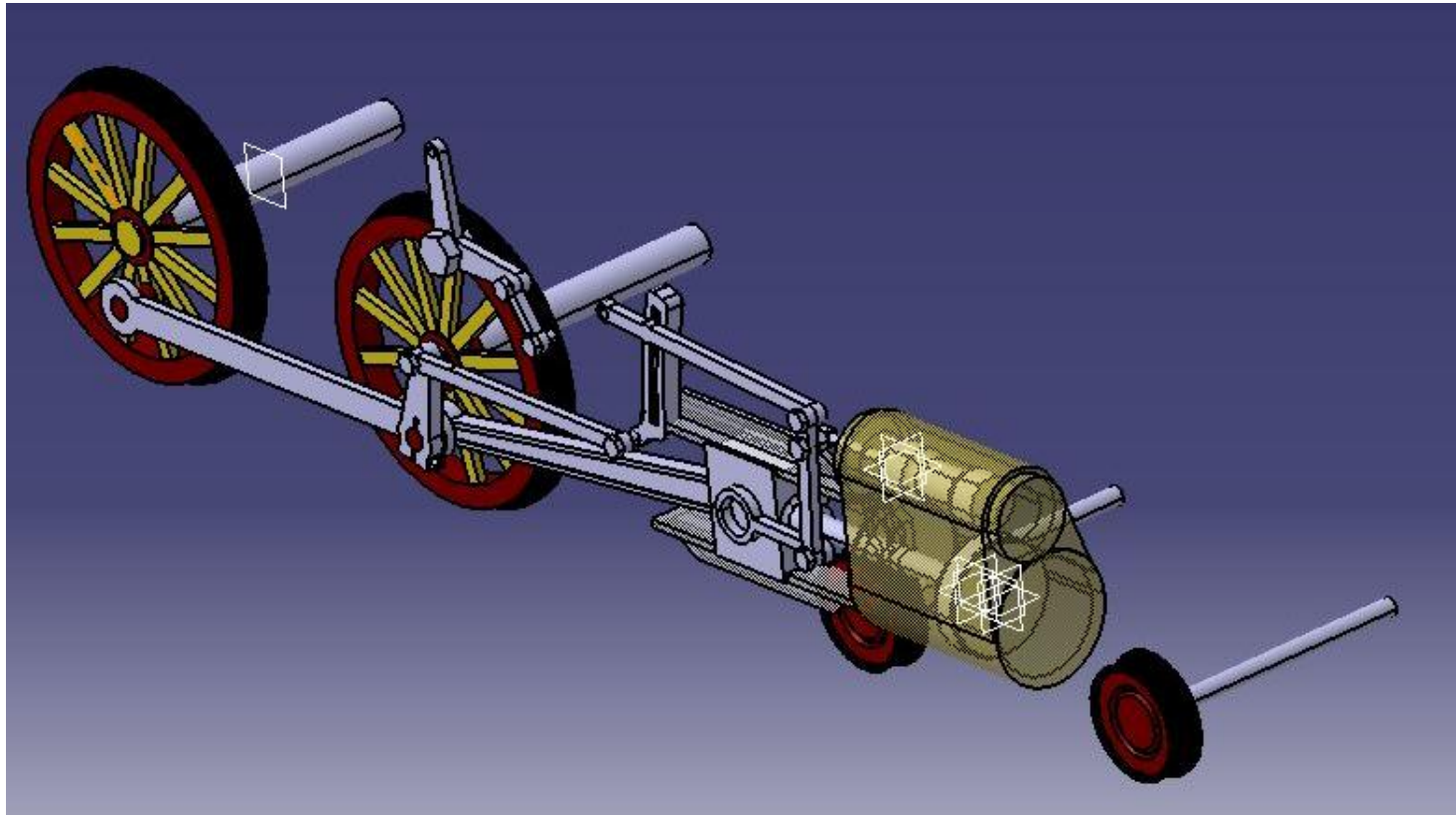

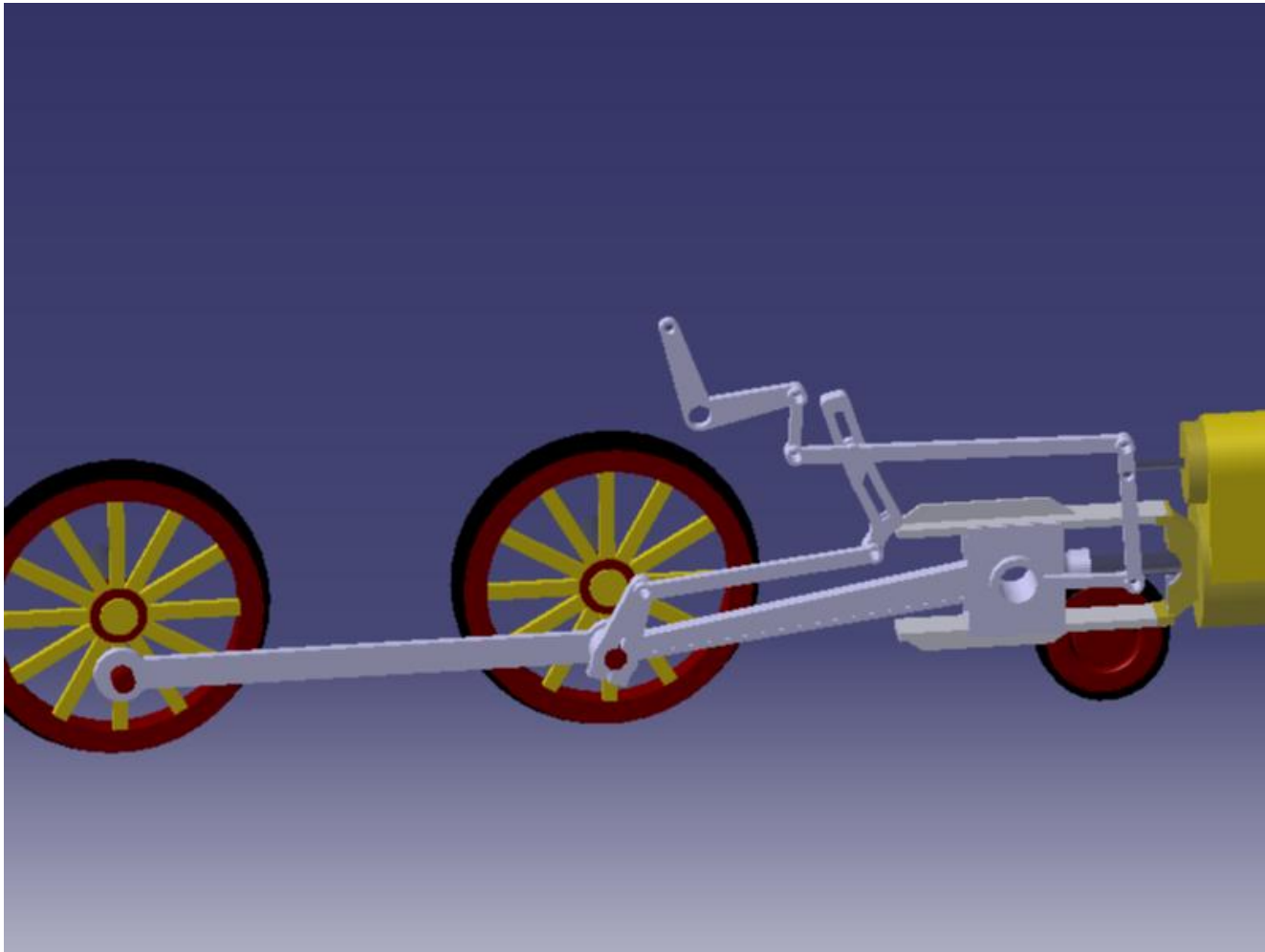

Kinematic

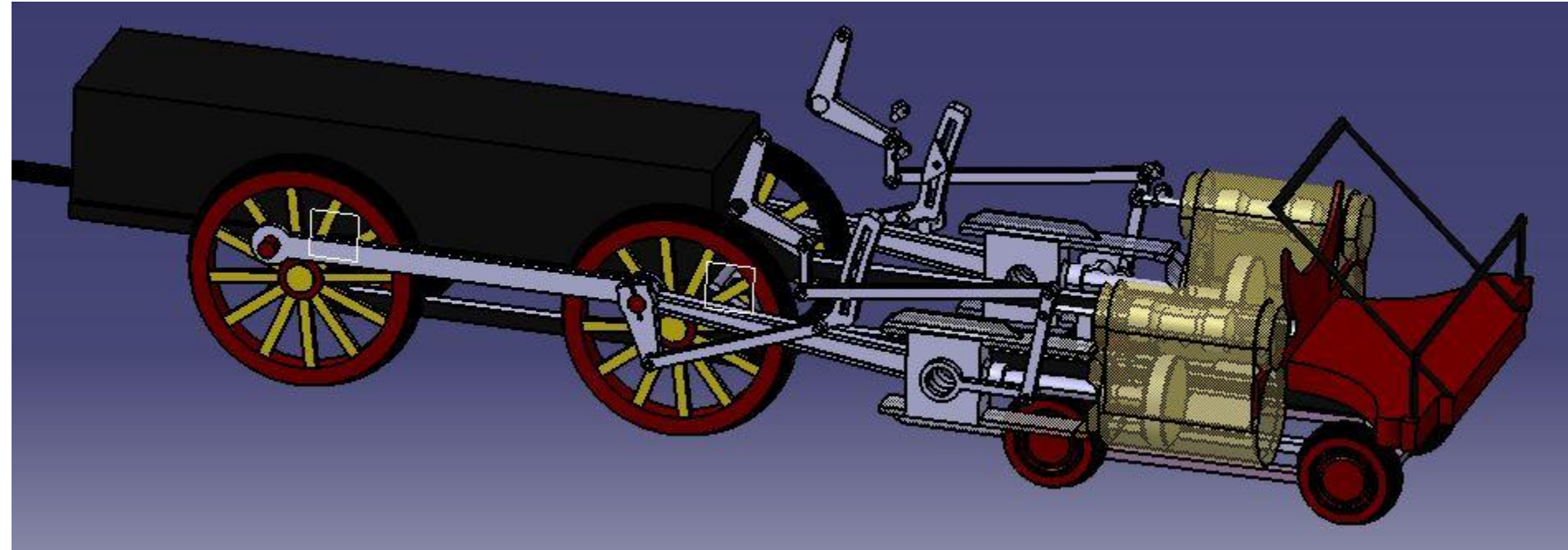

Kinematic

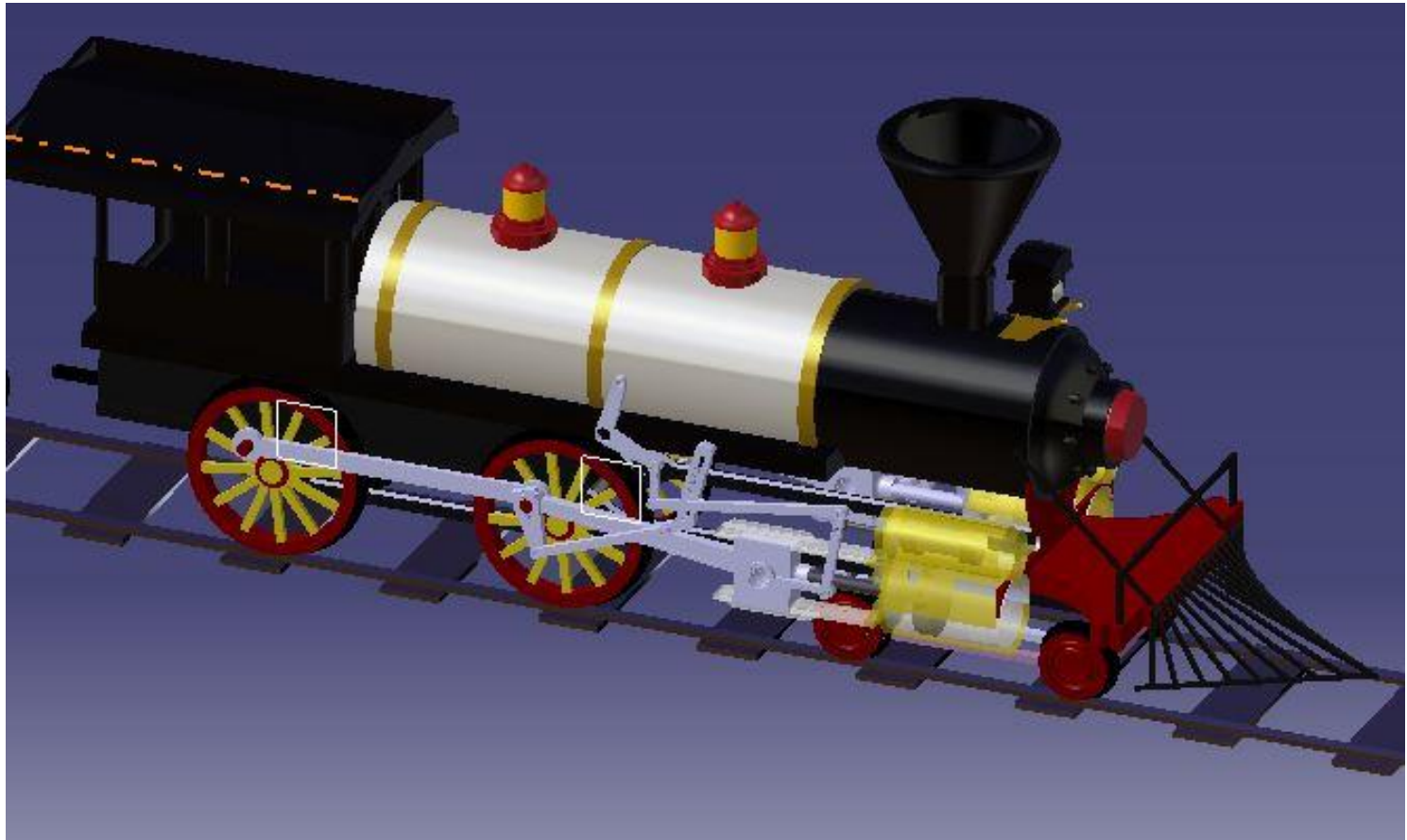

Kinematic

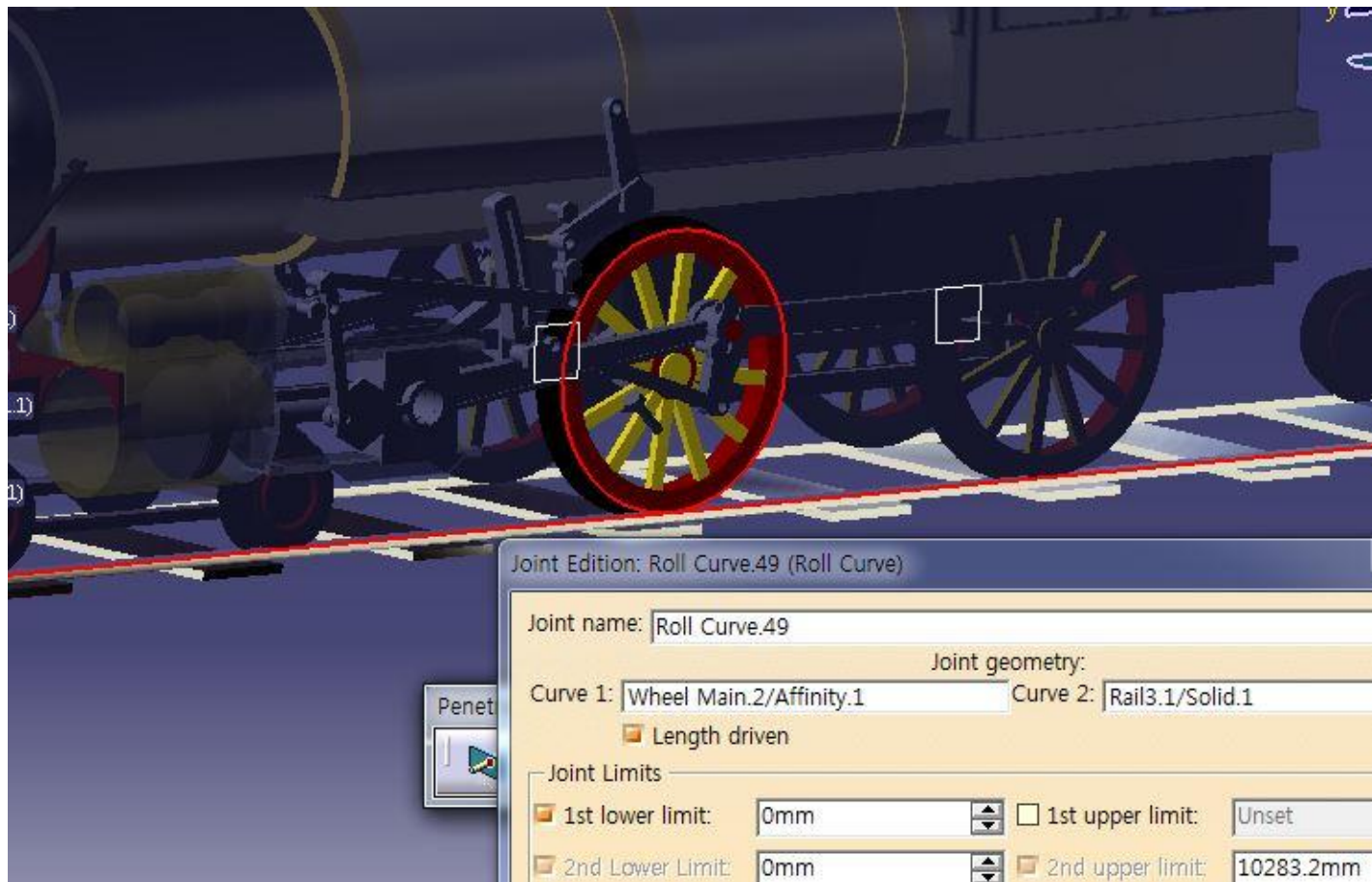

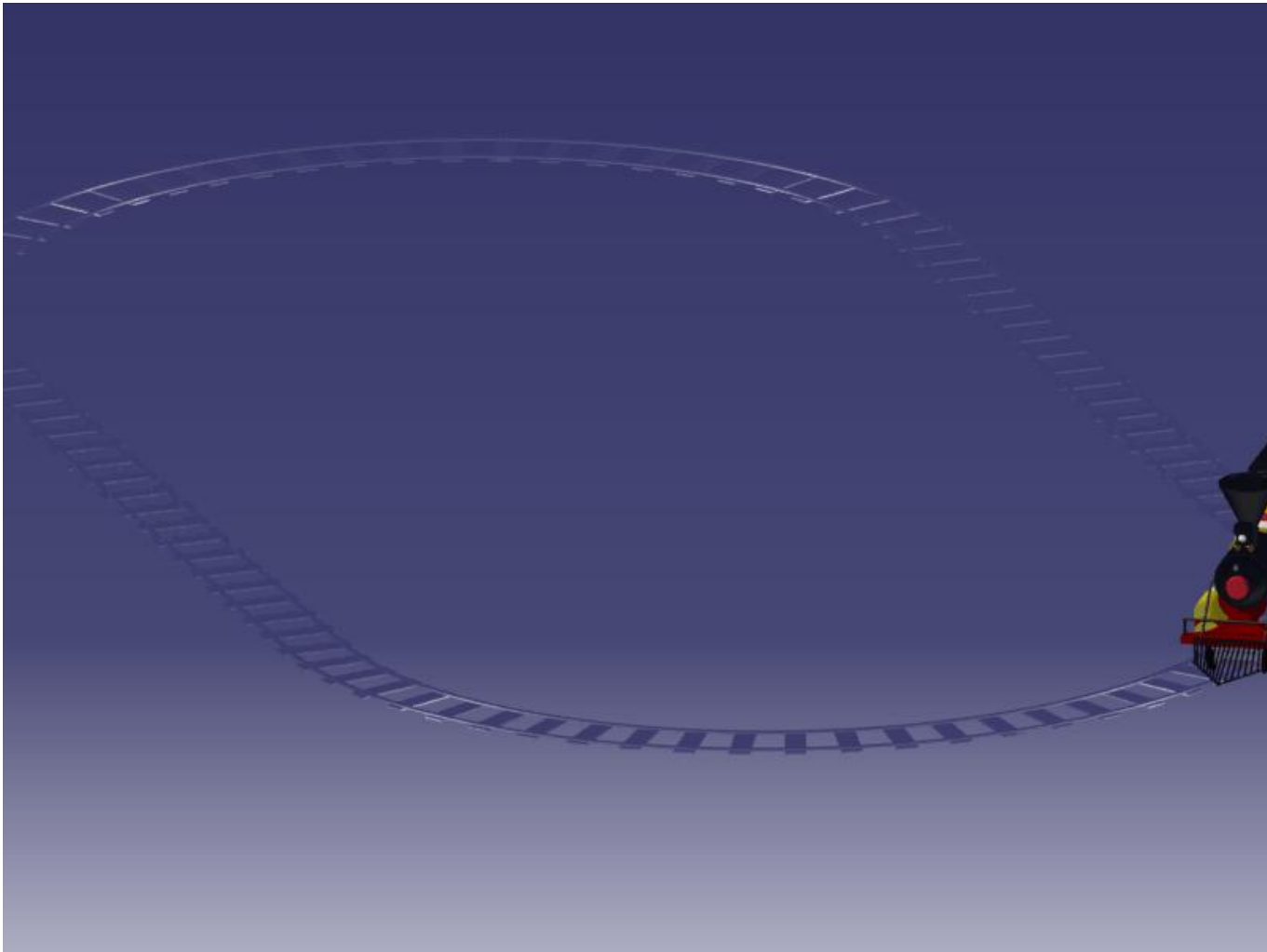

Kinematic

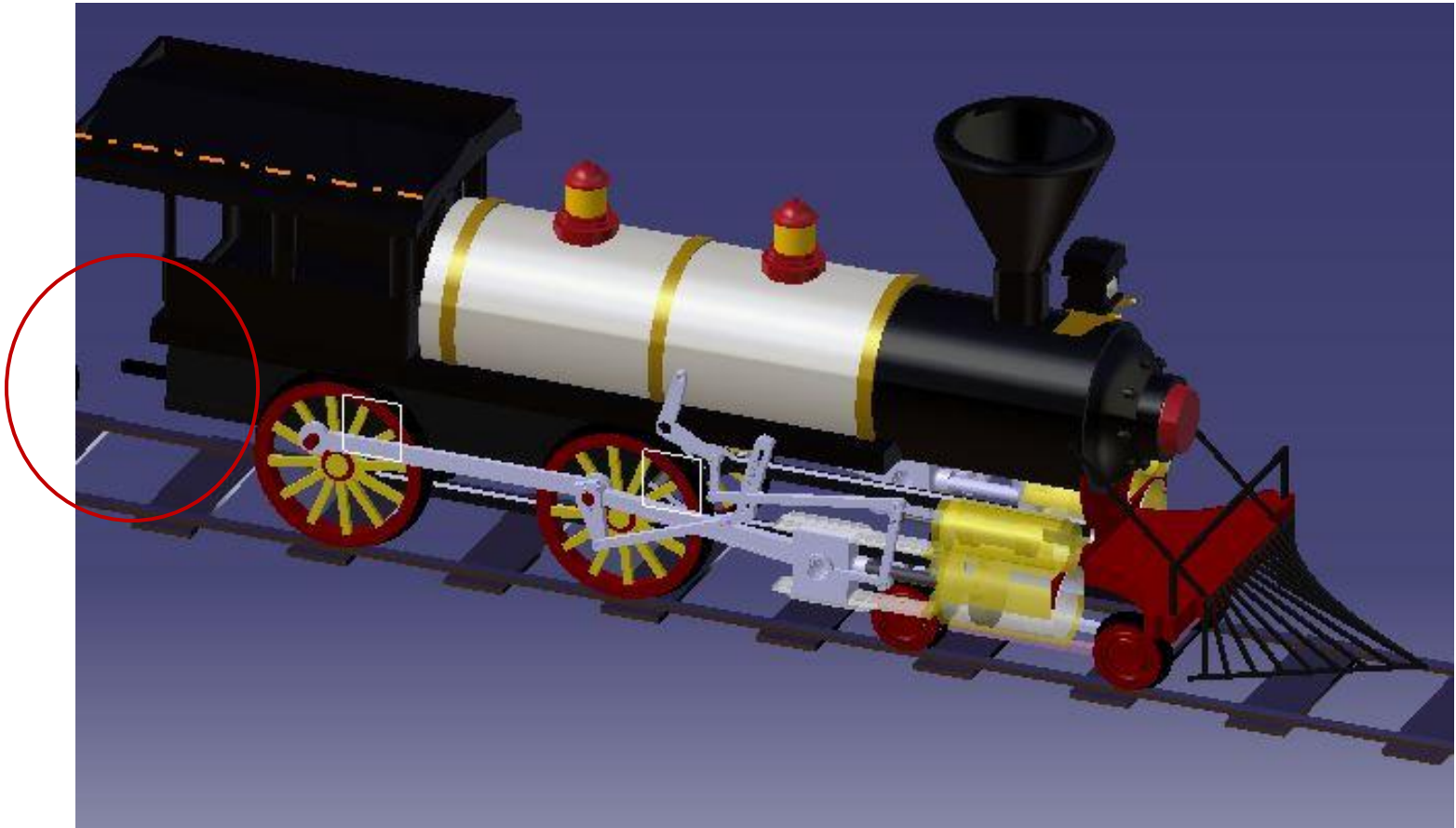

Kinematic

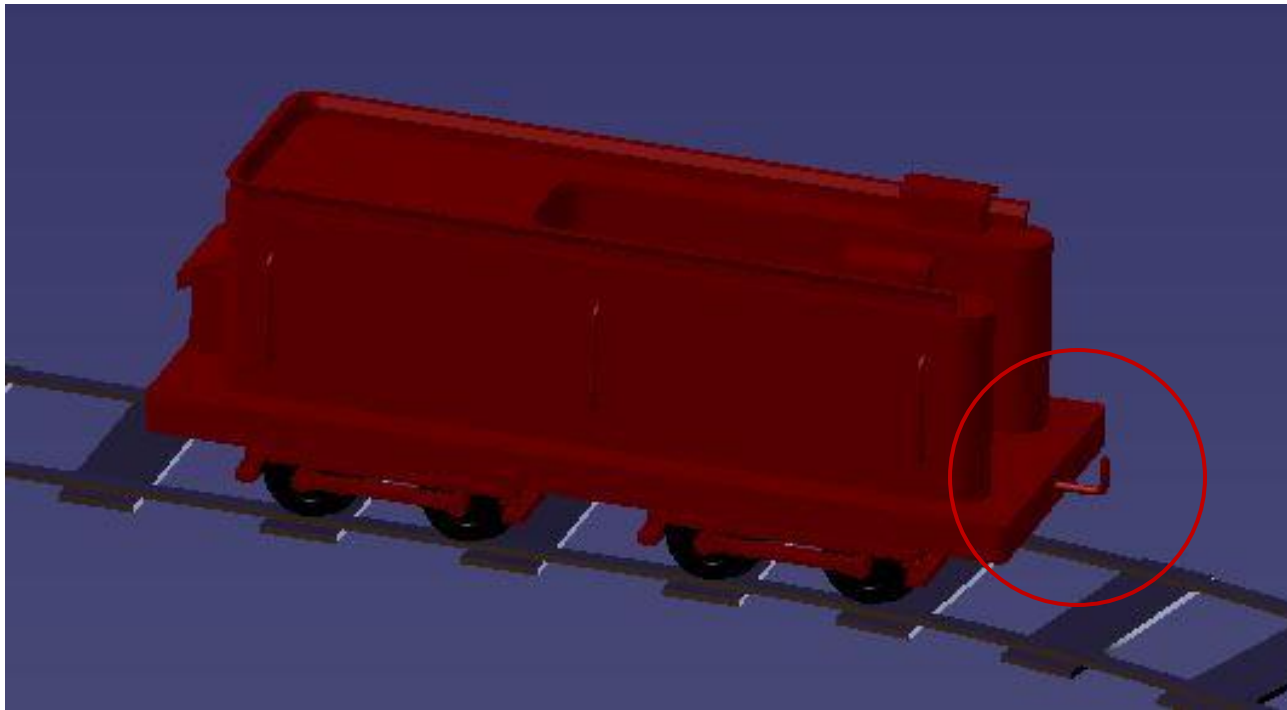

Kinematic

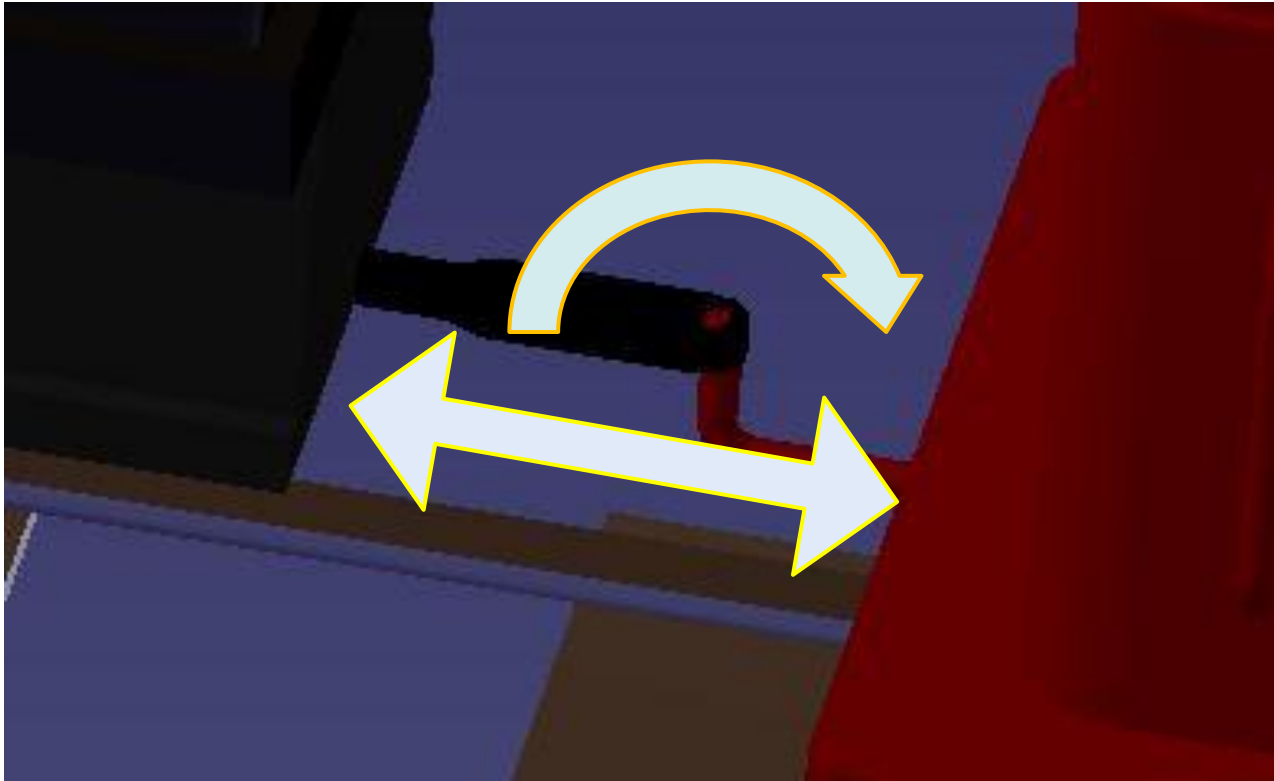

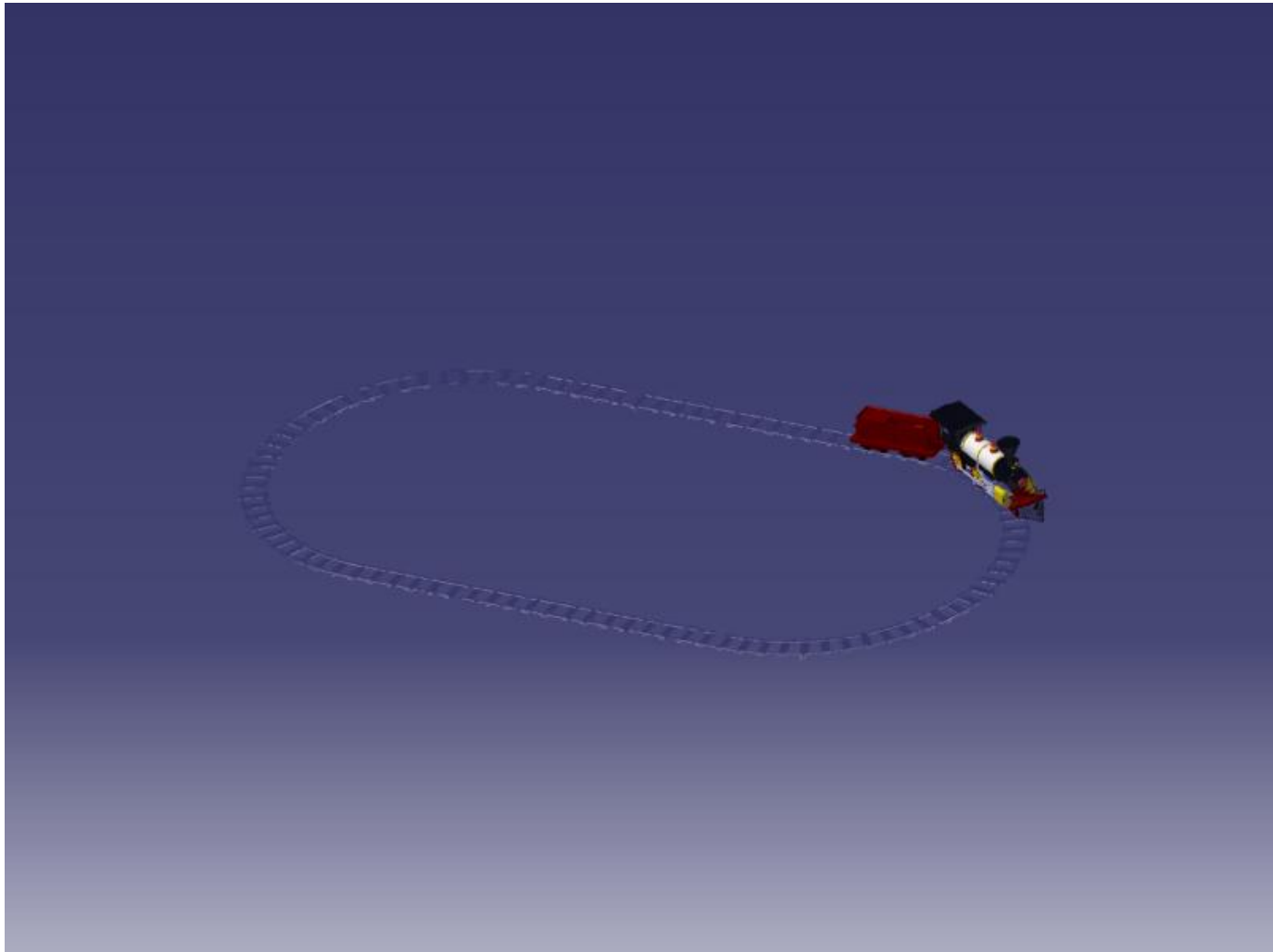

Error

1. 밸브기어의 독립적인 컨트롤 불가
2. 두 쌍의 바퀴만 레일에 맞물림
3. 기관차와 화물칸 연결의 끊어짐



Error

2. 두 쌍의 바퀴만 레일에 맞물림

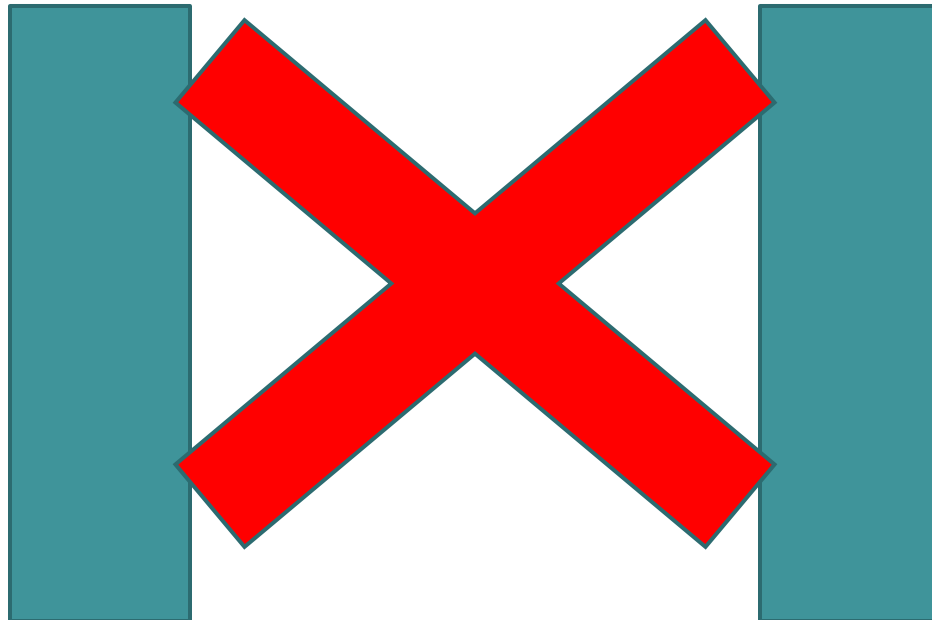

Error

2. 두 쌍의 바퀴만 레일에 맞물림

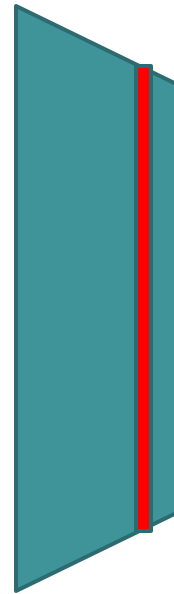
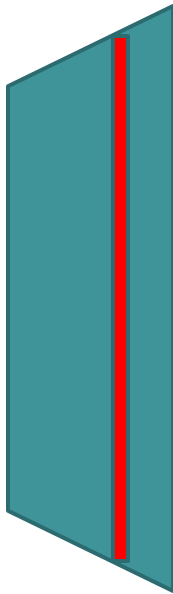

Error

3. 기관차와 화물칸 연결의 끊어짐

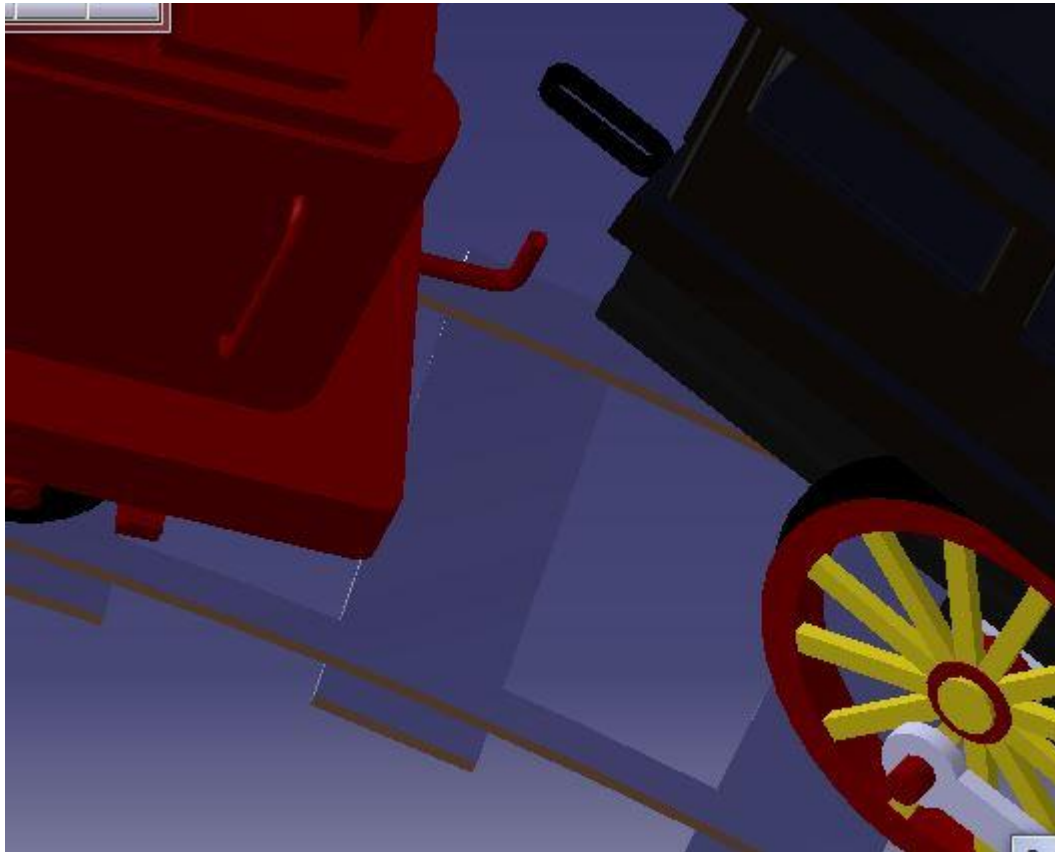

Error

3. 기관차와 화물칸 연결의 끊어짐
=>현재는 Sequence로 해결

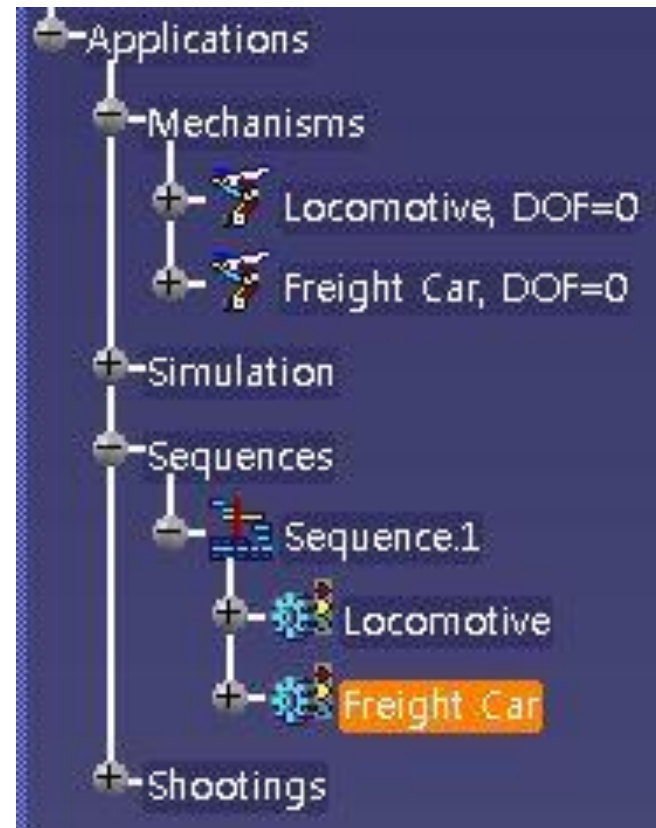



Q&A