

타워 브릿지

Tower Bridge

2018016162 차원석
2018015841 고영훈

B

r

i

d

g

e



CONTENTS

- 01** 주제 선정
Topic selection
- 02** 모델링 과정
Process of modeling
- 03** 키네마틱 영상
Kinematic simulation video
- 04** 후기
Review

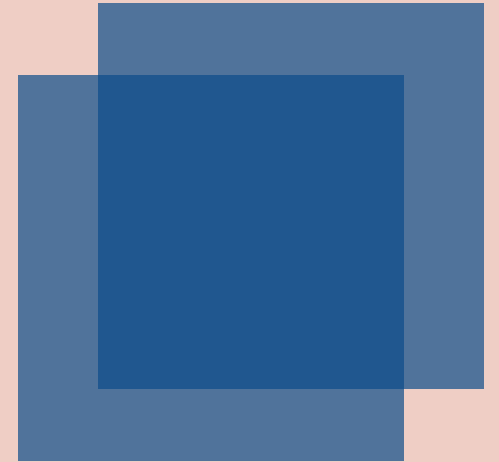

주제 선정

Topic selection



01 주제 선정

Topic selection



1. Kinematics을 통한
다양한 Simulation



2. 여러 part를 통한
많은 Catia 기능 활용 가능



3. 단순하지 않은
입체적인 스토리 연출 가능

01 제작 과정 구상

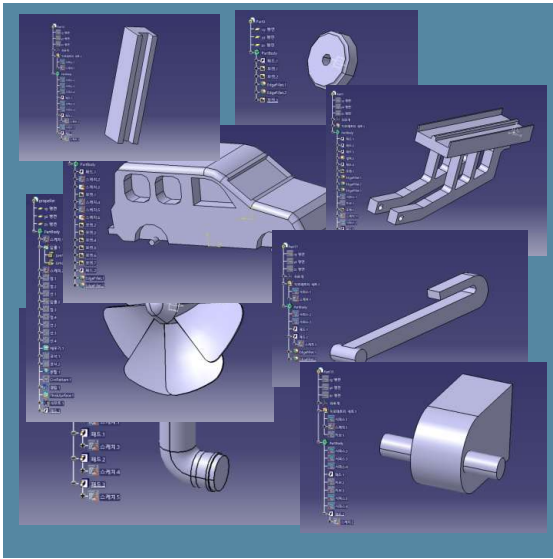

Part design

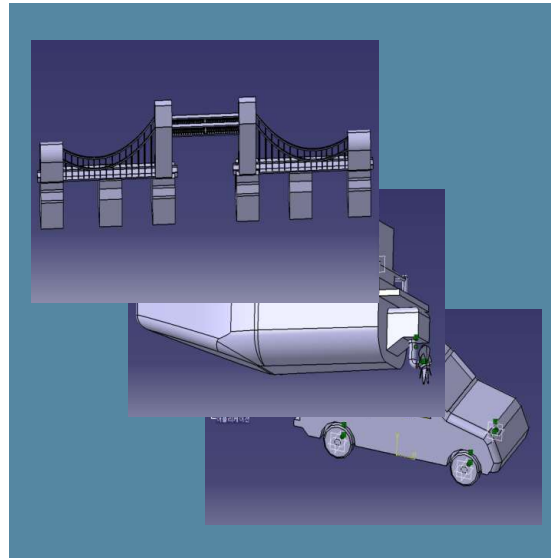

Assembly design

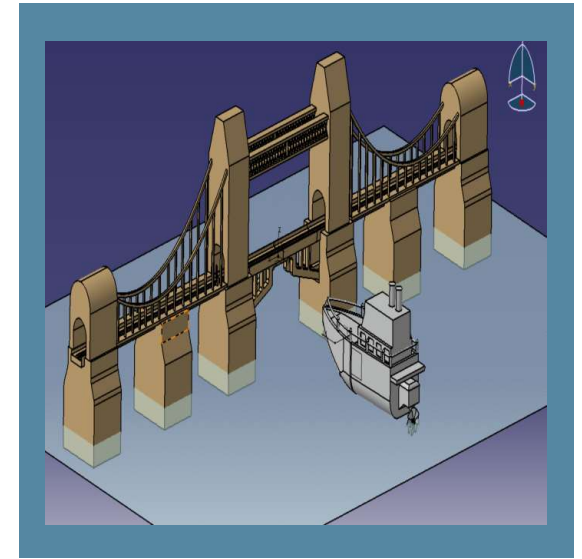

Kinematics simulation



모델링 과정

Process of modeling



The Tower Bridge.

Length of Bridge with its approaches	788 0 feet.	Depth of River at high water under central span,	32 1/2 feet.
" Northern approach	700 0 "	" lowest tides " " " "	22 "
" Southern approach	188 0 "	Clear headway at high water when the leaves are	
Width between N. and S. abutments.	110 "	down (varies from one part of the bridge to another)	30 to 35 1/2 feet.
of central span	300 "	Clear headway in centre span at high water with the	
of side spans, each	170 "	leaves raised	14 1/2 feet.

02 자동차 모델링

Car modeling

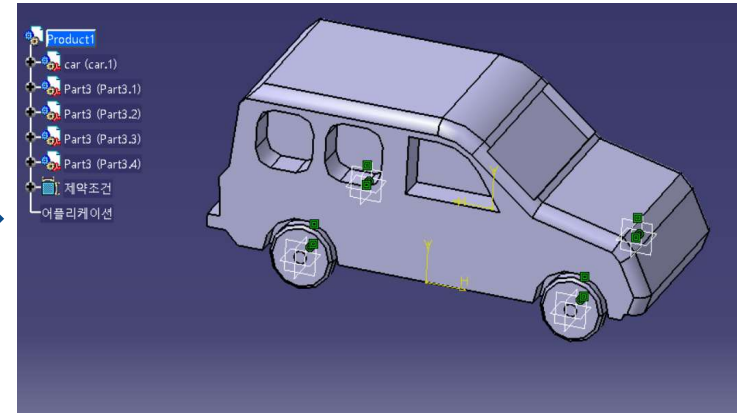
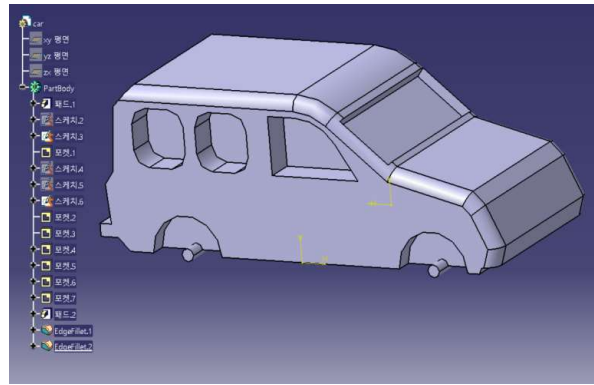
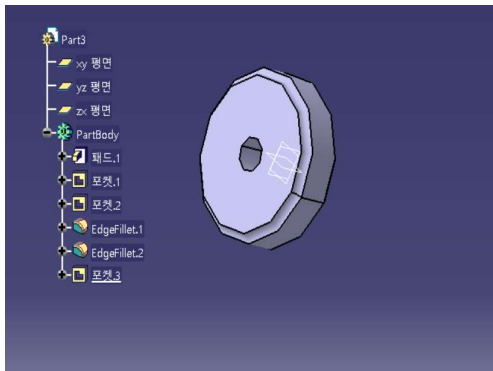

02 배 모델링

Ship modeling

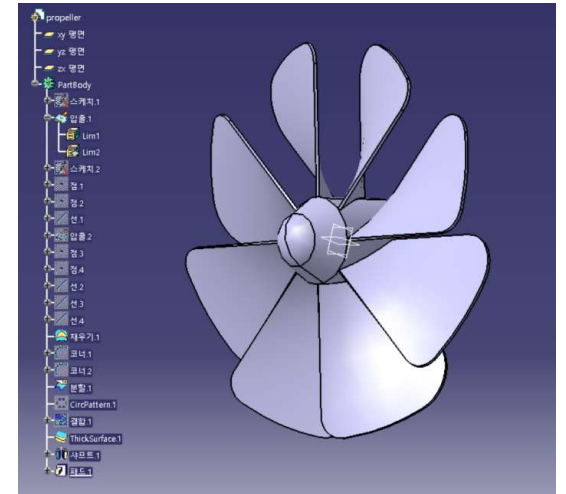
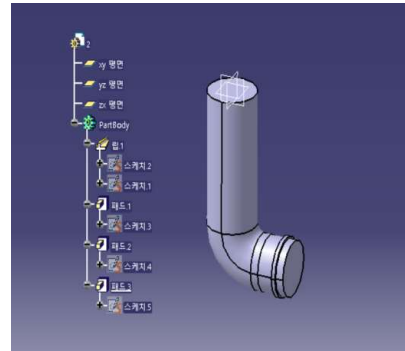
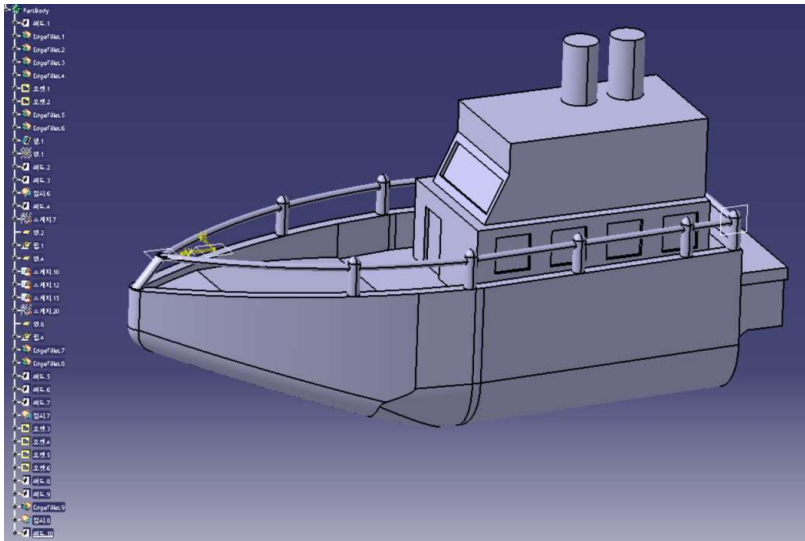

02 Assembly

Ship Assembly

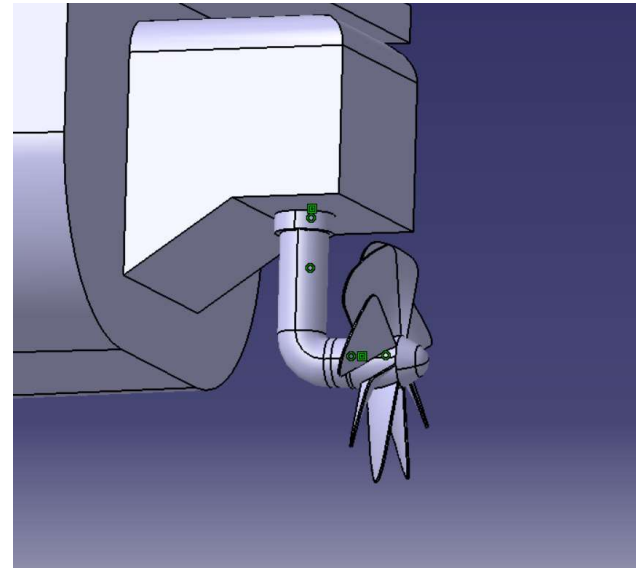
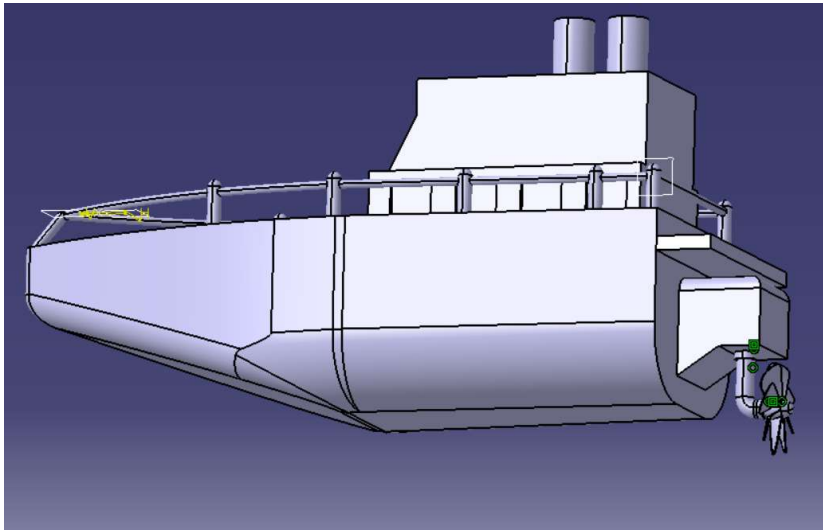

02 다리 (1) 모델링

Bridge (1) modeling

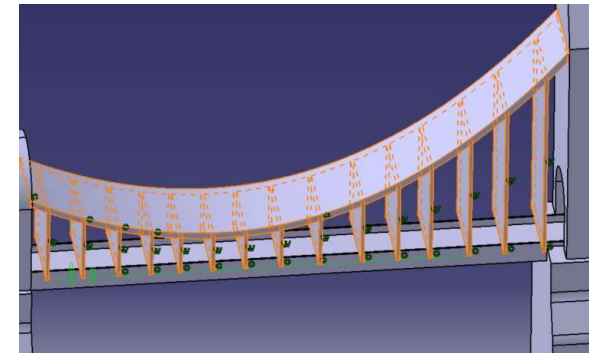
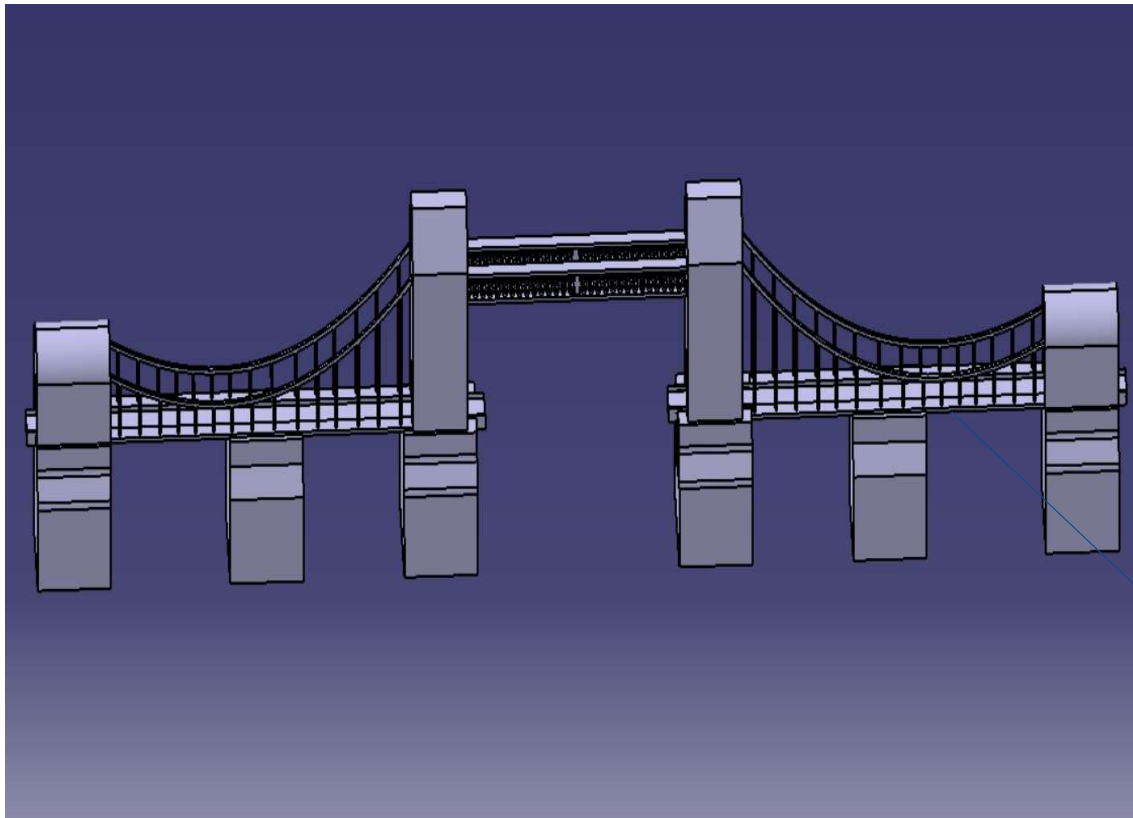
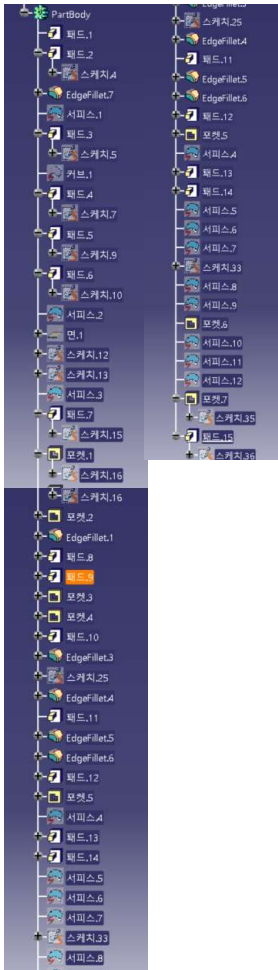

02 다리 (2) 모델링

Bridge (2) modeling

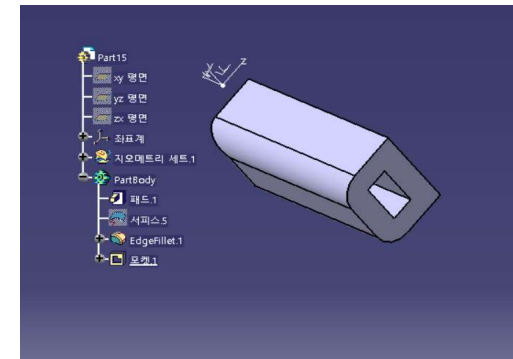
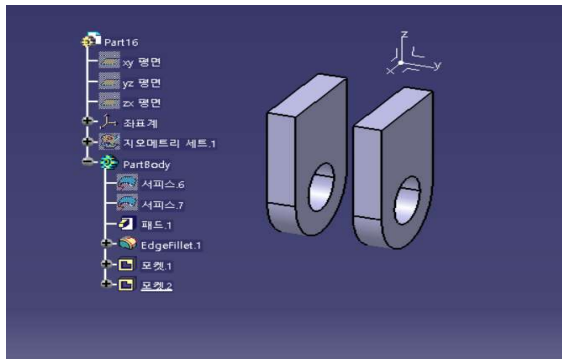
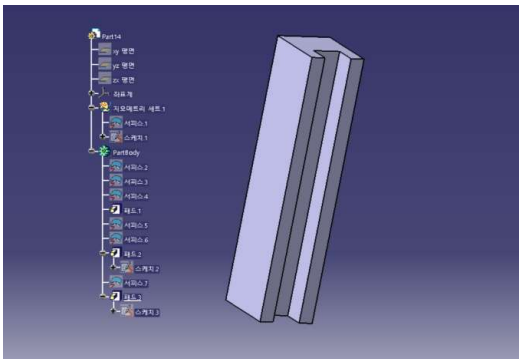
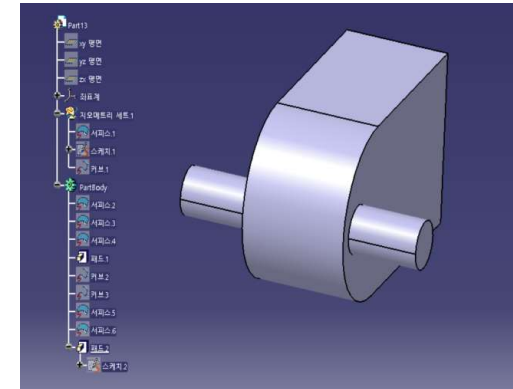
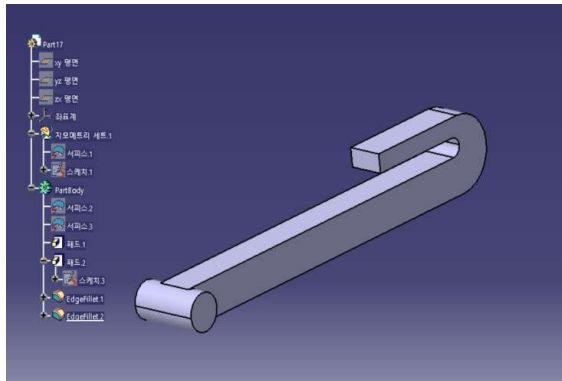
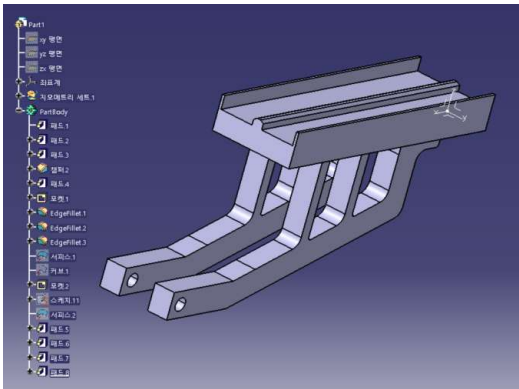

02 다리 (2) Assembly

Bridge (2) Assembly

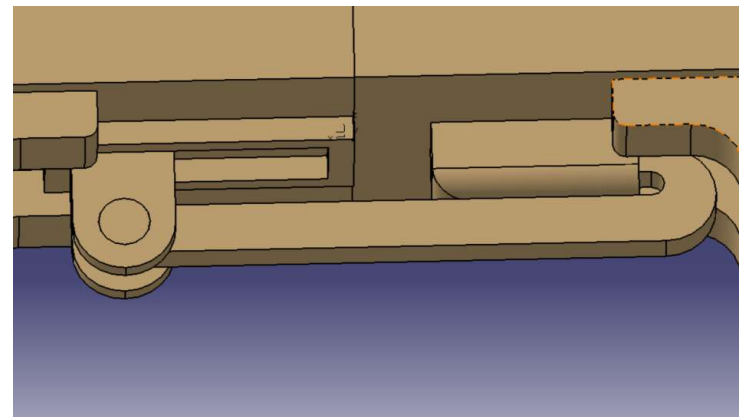
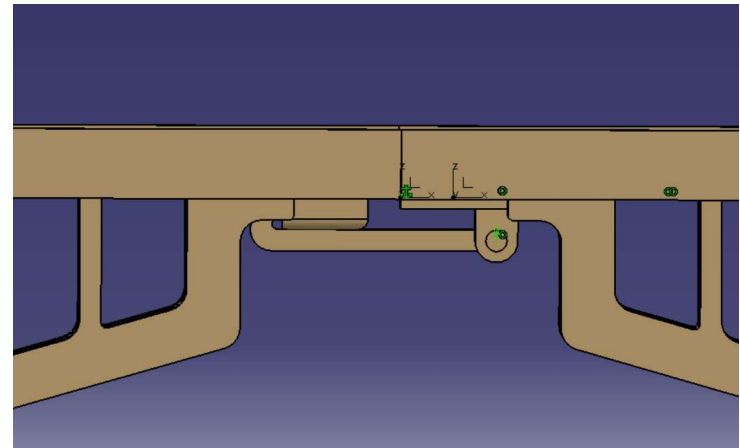
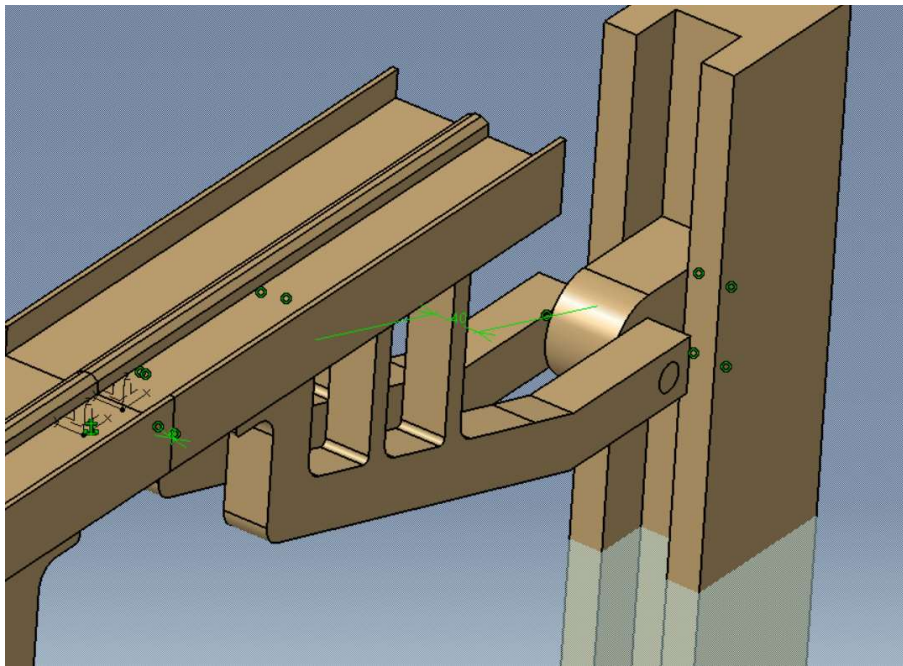

02 차단기 모델링

Crossing gate modeling

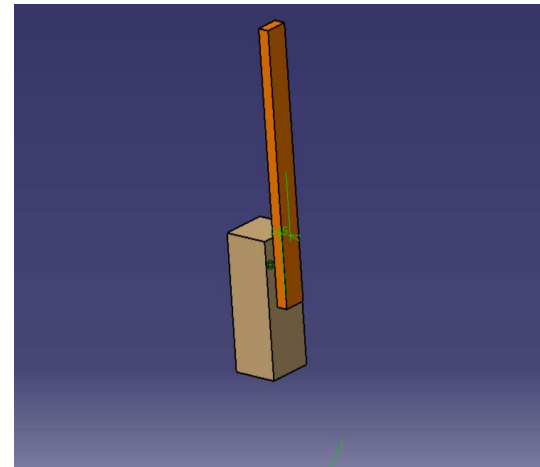
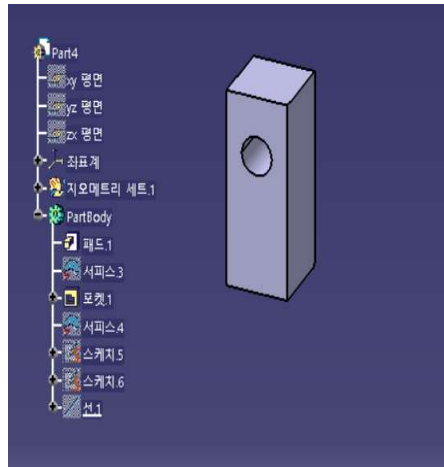
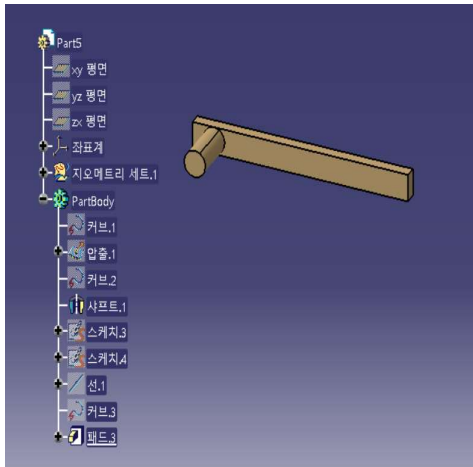

02 전체적인 배치

Total Assembly

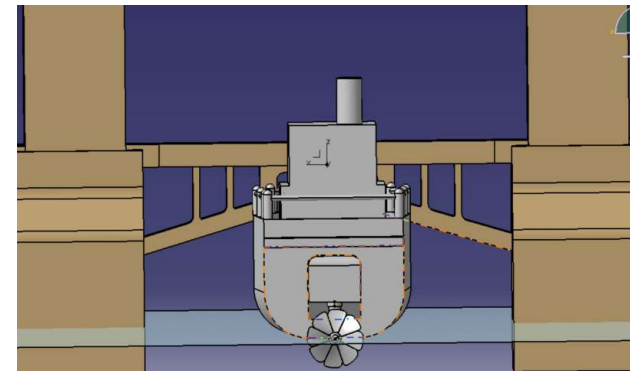
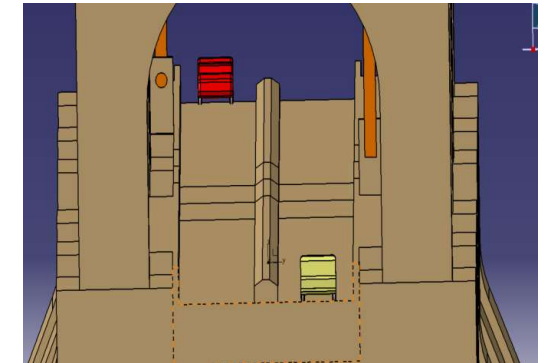
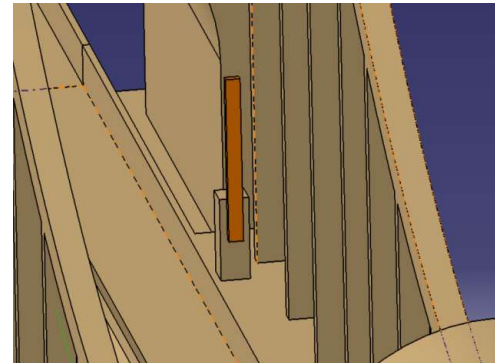
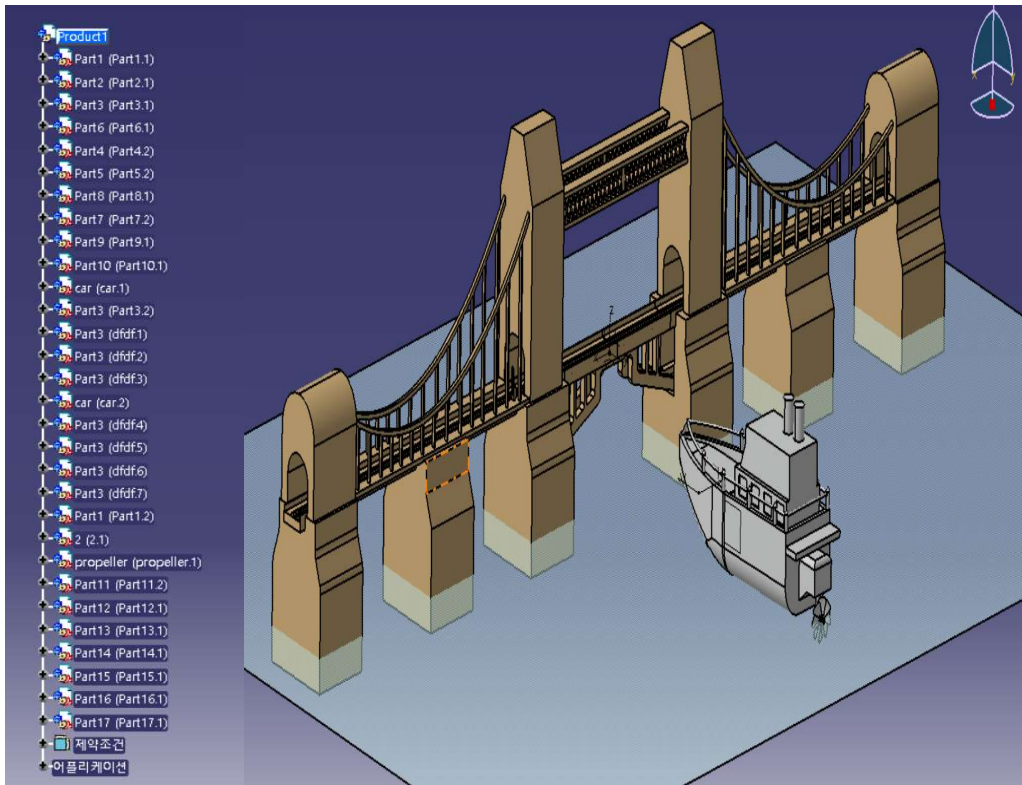

키네마틱 영상

Kinematic Simulation video

CHAPTER

3

03 Video

<https://youtu.be/wWSxPRiLFIQ>

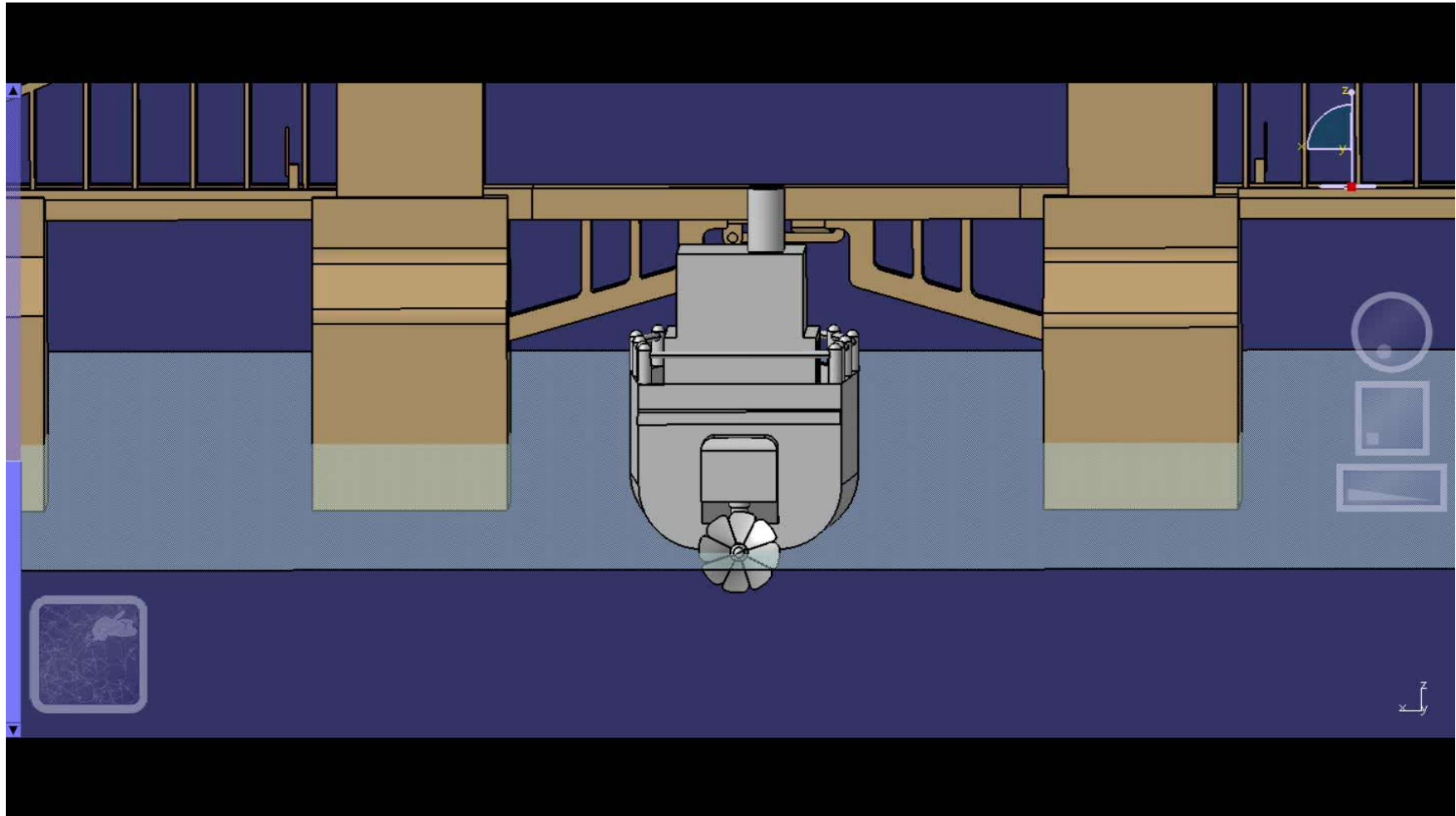

04

후기
Review

REVIEWS



04 제작 시 어려웠던 점

1. Outsourcing 없이 모델을 직접 만들어 시간적 한계가 컸음
2. 여러 Part의 규격이 상이하야 Product로 합칠 때 많은 수정 과정이 필요 하였음
3. 각 Simulation의 시간을 조정하여 연출하는데 어려움이 있었음

Thank
You